

Basınç Gazı Pressure Gas : Nitrogen N2  
 Max. Basınç Max. load pressure : 150 bar  
 Min. Basınç Min. load pressure : 25 bar  
 Çalışma Sıcaklığı Working Temperature : 0°C ve +80°C  
 Max Çalışma Hızı Max. operating speed : 1,8 m / s

Kod Code	Kurs Stroke	L	Lmin	daN	Kg	Alt Görünüm Bottom View
SN 150-10	10	70	60	150	~0,28	
SN 150-13	13	75,4	62,7		~0,29	
SN 150-16	16	82	66		~0,30	
SN 150-25	25	100	75		~0,33	
SN 150-38	38	126	88		~0,36	
SN 150-50	50	150	100		~0,40	
SN 150-63	63	177	113,5		~0,44	
SN 150-80	80	210	130		~0,49	
SN 150-100	100	250	150		~0,55	
SN 150-125	125	300	175		~0,64	

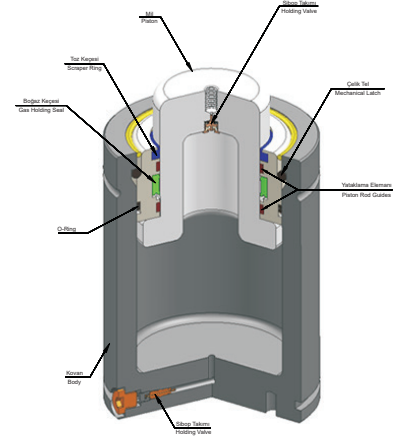
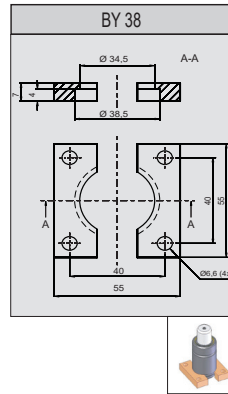
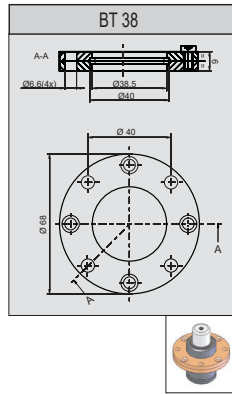
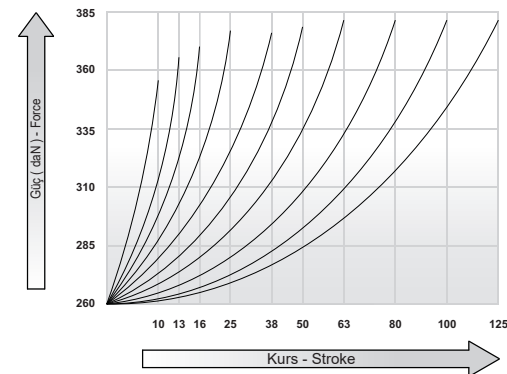
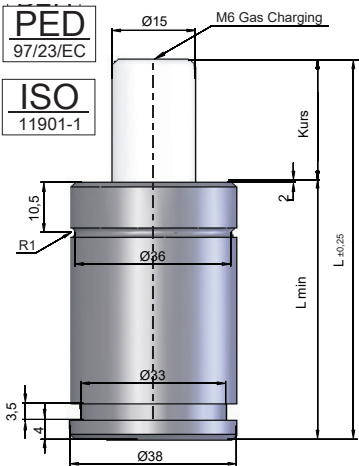

Basınç Gazı Pressure Gas : Nitrogen N2  
 Max. Basınç Max. load pressure : 150 bar  
 Min. Basınç Min. load pressure : 25 bar  
 Çalışma Sıcaklığı Working Temperature : 0°C ve +80°C  
 Max Çalışma Hızı Max. operating speed : 1,8 m / s

Kod Code	Kurs Stroke	L	Lmin	daN	Kg	Alt Görünüm Bottom View
SN 250-10	10	70	60	250	~0,40	
SN 250-13	13	75,4	62,7		~0,41	
SN 250-16	16	82	66		~0,43	
SN 250-25	25	100	75		~0,48	
SN 250-38	38	126	88		~0,54	
SN 250-50	50	150	100		~0,60	
SN 250-63	63	177	113,5		~0,66	
SN 250-80	80	210	130		~0,74	
SN 250-100	100	250	150		~0,81	
SN 250-125	125	300	175		~0,98	

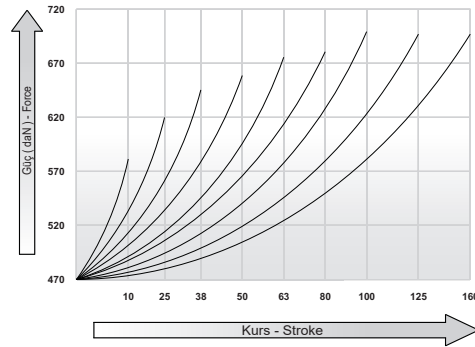
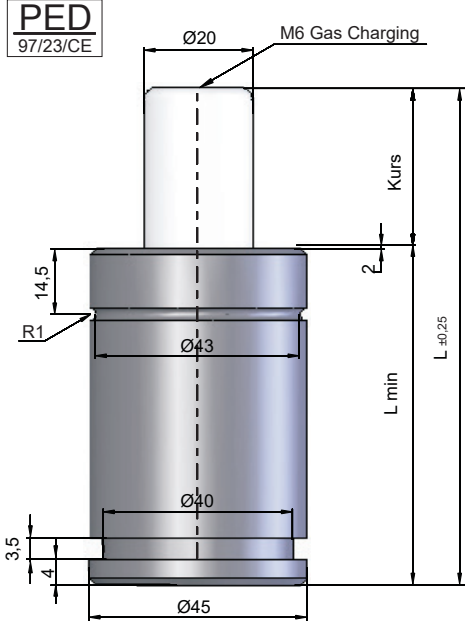

Basınç Gazı : Nitrogen N2  
 Pressurè Gas  
 Max. Basınç : 150 bar  
 Max. load pressure  
 Min. Basınç : 25 bar  
 Min. load pressure  
 Çalışma Sıcaklığı : 0°C ve +80°C  
 Working Temperature  
 Max Çalışma Hızı : 1,8 m / s  
 Max. operating speed

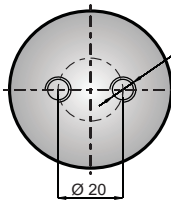
Kod Code	Kurs Stroke	L	Lmin	daN	Kg	Alt Görünüm Bottom View
SN 500-13	13	110,4	97,7	500	~ 0,90	
SN 500-25	25	135	110		~ 1,00	
SN 500-38	38	161	123		~ 1,10	
SN 500-50	50	185	135		~ 1,20	
SN 500-63	63	212	148,5		~ 1,30	
SN 500-80	80	245	165		~ 1,40	
SN 500-100	100	285	185		~ 1,60	
SN 500-125	125	335	210		~ 1,80	
SN 500-160	160	405	245	~ 2,10		

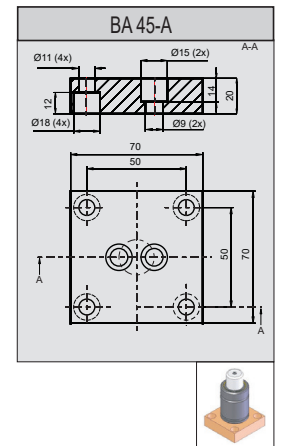
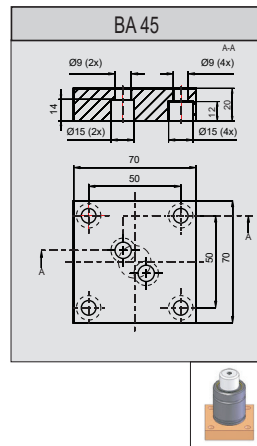
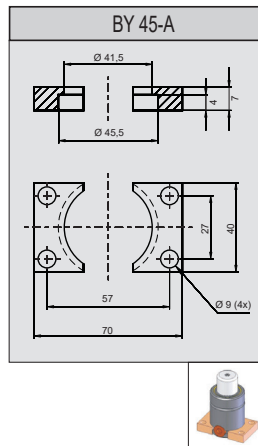
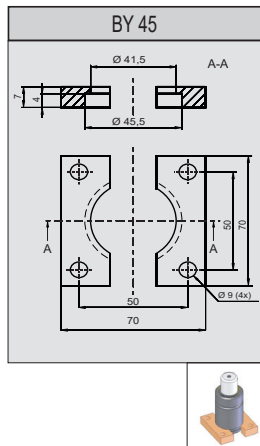
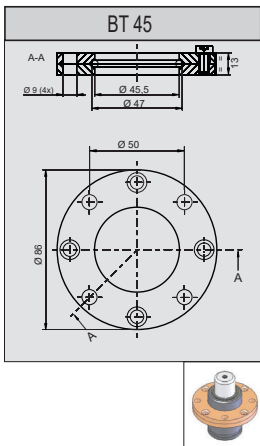
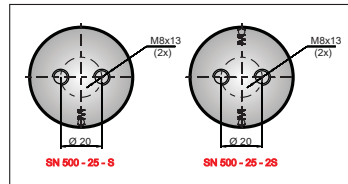
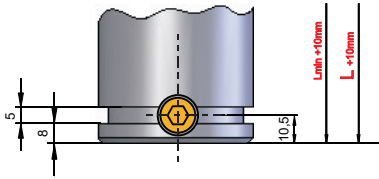
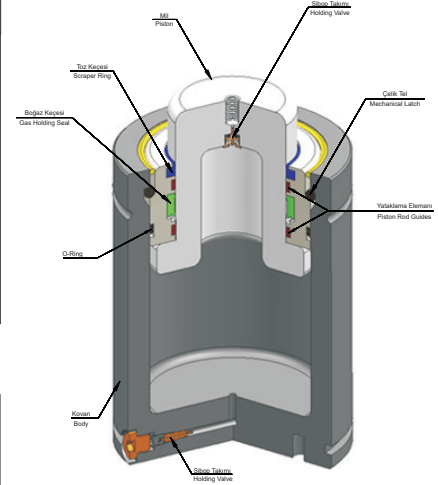

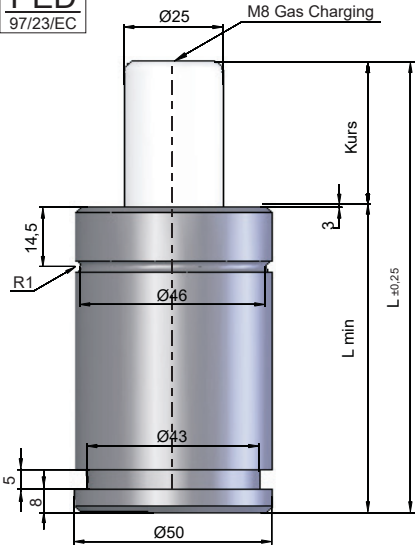
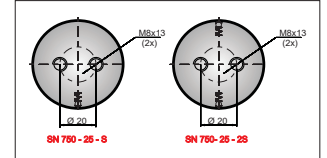
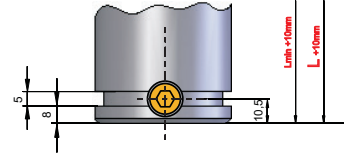
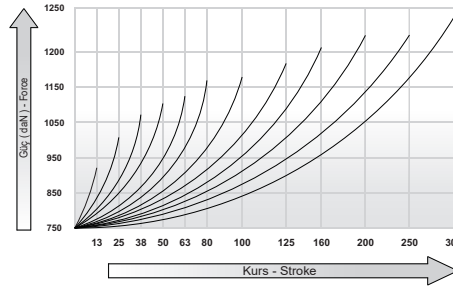
**PED**  
 97/23/EC

**ISO**  
 11901-1

Basınç Gazı : Nitrogen N2  
 Pressurè Gas  
 Max. Basınç : 150 bar  
 Max. load pressure  
 Min. Basınç : 25 bar  
 Min. load pressure  
 Çalışma Sıcaklığı : 0°C ve +80°C  
 Working Temperature  
 Max Çalışma Hızı : 1,8 m / s  
 Max. operating speed

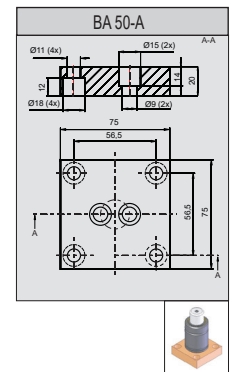
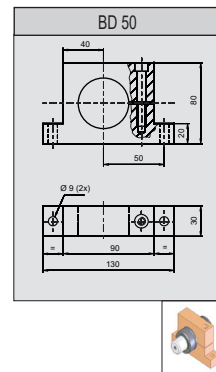
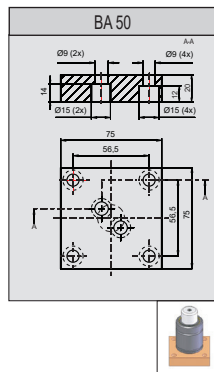
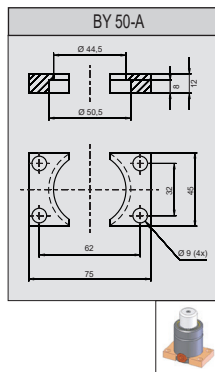
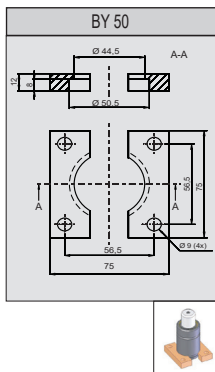
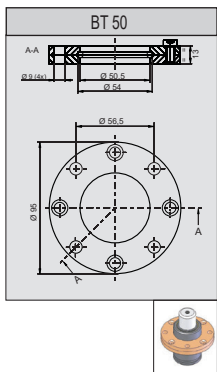
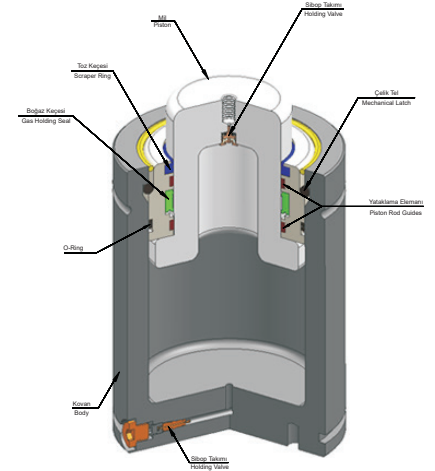
Kod Code	Kurs Stroke	L	Lmin	daN	Kg	Alt Görünüm Bottom View
SN 750-13	13	120,4	107,7	750	~ 1,25	
SN 750-25	25	145	120		~ 1,38	
SN 750-38	38	171	133		~ 1,53	
SN 750-50	50	195	145		~ 1,65	
SN 750-63	63	222	158,5		~ 1,80	
SN 750-80	80	255	175		~ 1,96	
SN 750-100	100	295	195		~ 2,09	
SN 750-125	125	345	220		~ 2,33	
SN 750-160	160	415	255		~ 2,68	
SN 750-200	200	495	295		~ 3,10	
SN 750-250	250	595	345	~ 3,60		
SN 750-300	300	695	395	~ 4,10		

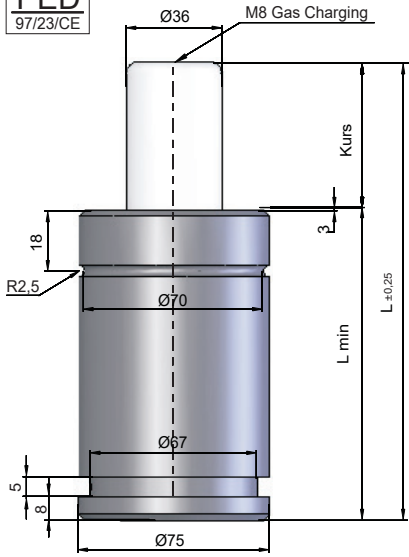
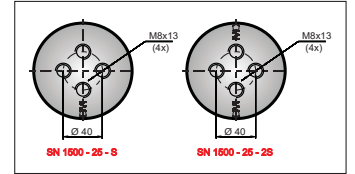
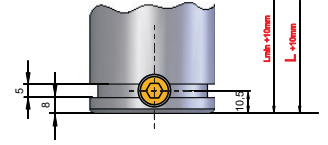
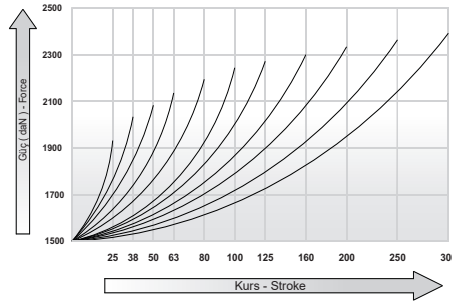

PED  
 97/23/CE

 ISO  
 11901-1

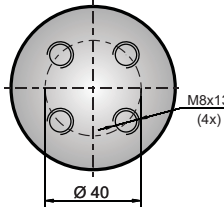
Basınç Gazı : Nitrogen N2  
 Pressuré Gas : Nitrogen N2  
 Max. Basınç : 150 bar  
 Max. load pressure : 150 bar  
 Min. Basınç : 25 bar  
 Min. load pressure : 25 bar  
 Çalışma Sıcaklığı : 0°C ve +80°C  
 Working Temperature : 0°C ve +80°C  
 Max Çalışma Hızı : 1,8 m / s  
 Max. operating speed : 1,8 m / s

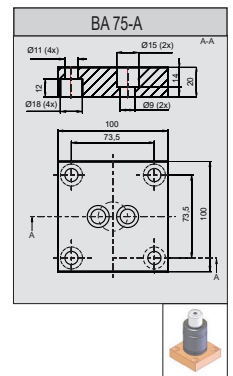
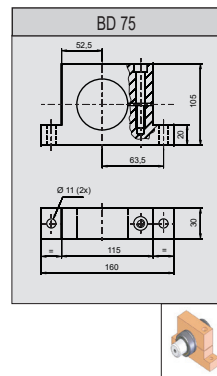
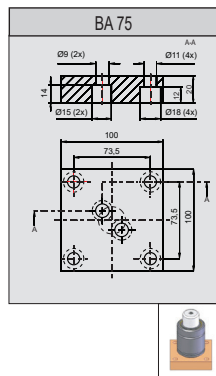
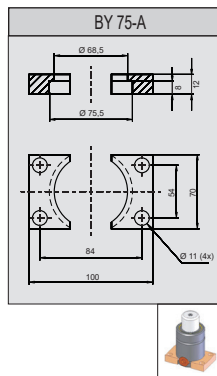
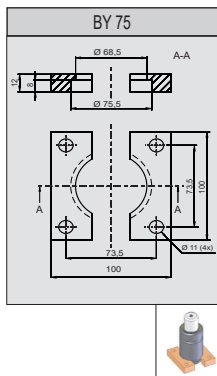
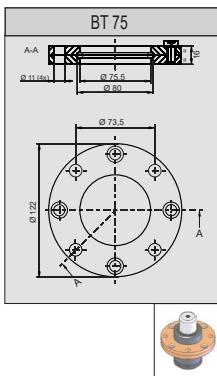
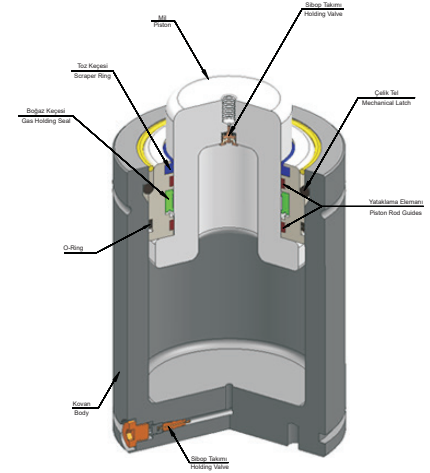
Kod Code	Kurs Stroke	L	Lmin	daN	Kg	Alt Görünüm Bottom View
SN 1500-25	25	160	135	1500	~ 3,64	
SN 1500-38	38	186	148		~ 3,91	
SN 1500-50	50	210	160		~ 4,15	
SN 1500-63	63	237	173,5		~ 4,47	
SN 1500-80	80	270	190		~ 4,81	
SN 1500-100	100	310	210		~ 5,22	
SN 1500-125	125	360	235		~ 5,75	
SN 1500-160	160	430	270		~ 6,33	
SN 1500-200	200	510	310		~ 7,34	
SN 1500-250	250	610	360		~ 8,50	
SN 1500-300	300	710	410	~ 9,60		

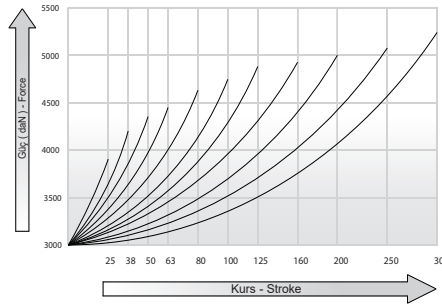
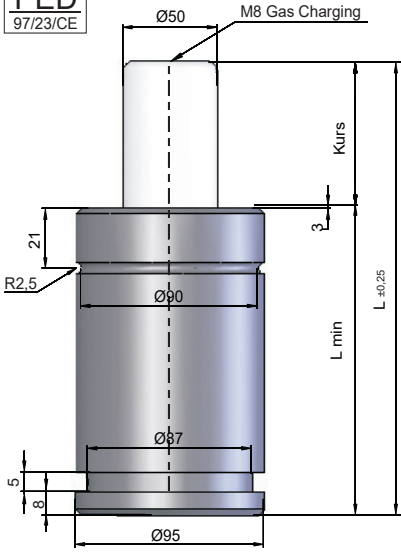
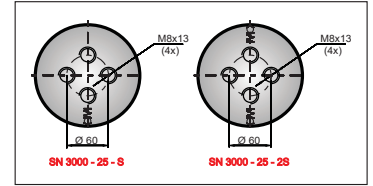
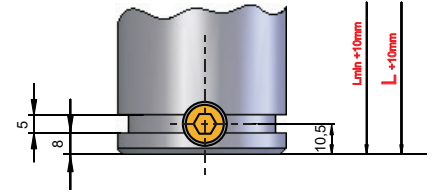

**PED**  
97/23/CE

**ISO**  
11901-1

**Başıç Gazı** : Nitrogen N2  
**Pressure Gas** : Nitrogen N2  
**Max. Başıç** : 150 bar  
**Max. load pressure** : 150 bar  
**Min. Başıç** : 25 bar  
**Min. load pressure** : 25 bar  
**Çalıřma Sıcaklıđı** : 0°C ve +80°C  
**Working Temperature** : 0°C ve +80°C  
**Max Çalıřma Hızı** : 1,8 m / s  
**Max. operating speed** : 1,8 m / s

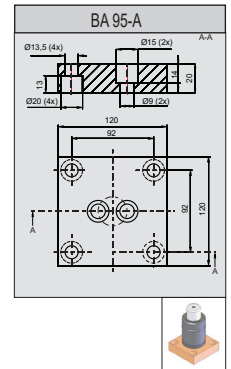
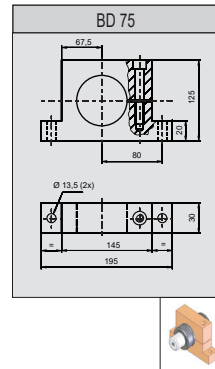
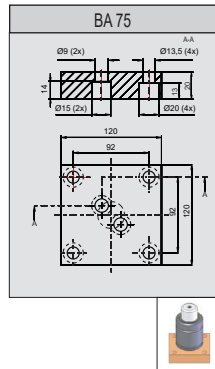
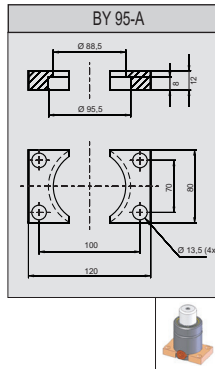
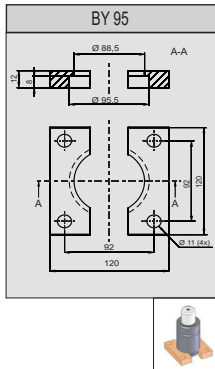
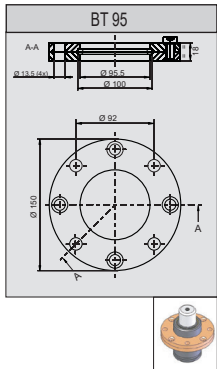
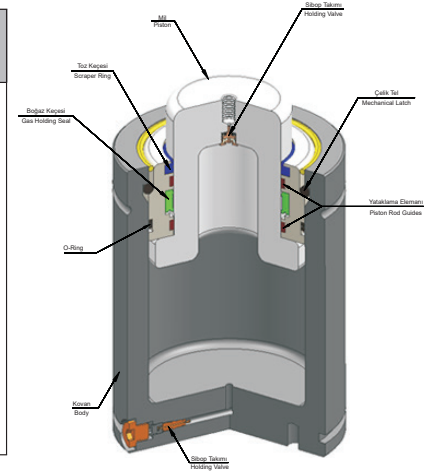
Kod Code	Kurs Stroke	L	Lmin	daN	Kg	Alt Görünüm Bottom View
SN 3000-25	25	170	145	3000	~ 6,36	
SN 3000-38	38	196	158		~ 6,75	
SN 3000-50	50	220	170		~ 7,35	
SN 3000-63	63	247	183,5		~ 7,87	
SN 3000-80	80	280	200		~ 8,44	
SN 3000-100	100	320	220		~ 9,03	
SN 3000-125	125	370	245		~ 10,1	
SN 3000-160	160	440	280		~ 11,3	
SN 3000-200	200	520	320		~ 12,8	
SN 3000-250	250	620	370		~ 14,5	
SN 3000-300	300	720	420	~ 16,2		

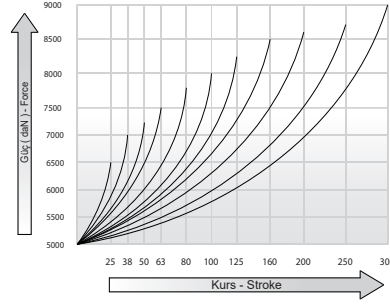
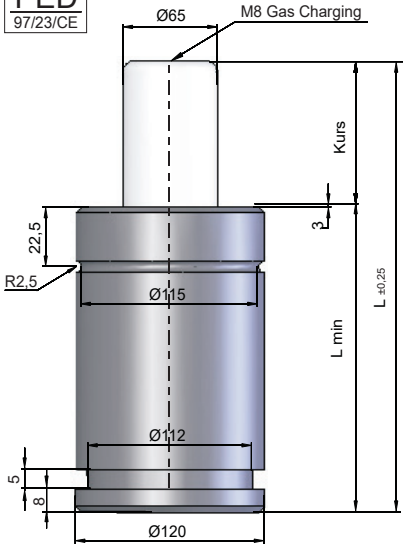
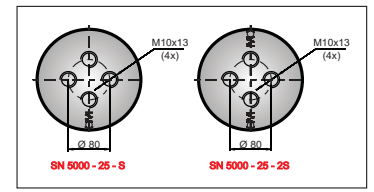
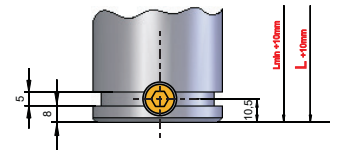

**PED**  
 97/23/CE

**ISO**  
 11901-1

Basınç Gazı : Nitrogen N2  
 Pressuré Gas : Nitrogen N2  
 Max. Basınç : 150 bar  
 Max. load pressure : 150 bar  
 Min. Basınç : 25 bar  
 Min. load pressure : 25 bar  
 Çalışma Sıcaklığı : 0°C ve +80°C  
 Working Temperature : 0°C ve +80°C  
 Max Çalışma Hızı : 1,8 m / s  
 Max. operating speed : 1,8 m / s

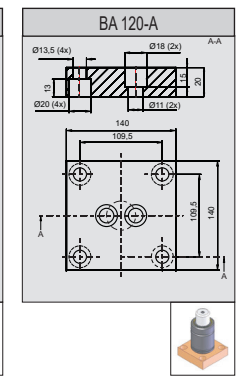
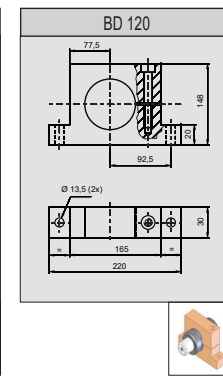
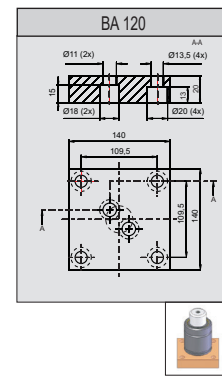
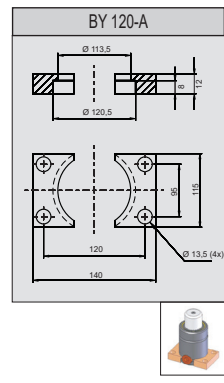
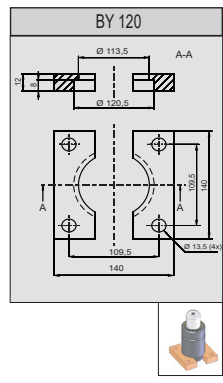
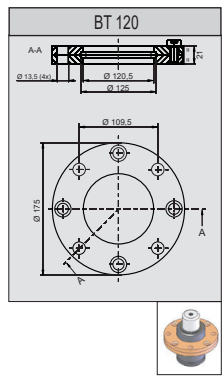
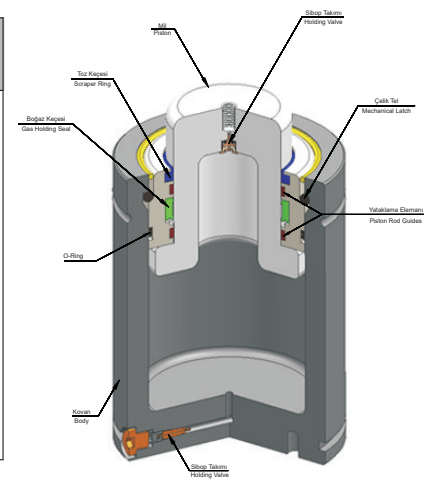
Kod Code	Kurs Stroke	L	Lmin	daN	Kg	Alt Görünüm Bottom View
SN 5000-25	25	190	165	5000	~ 12,2	
SN 5000-38	38	216	178		~ 12,9	
SN 5000-50	50	240	190		~ 13,7	
SN 5000-63	63	267	203,5		~ 14,5	
SN 5000-80	80	300	220		~ 15,4	
SN 5000-100	100	340	240		~ 16,7	
SN 5000-125	125	390	265		~ 18,3	
SN 5000-160	160	460	300		~ 20,1	
SN 5000-200	200	540	340		~ 22,3	
SN 5000-250	250	640	390		~ 24,8	
SN 5000-300	300	740	440	~ 27,3		

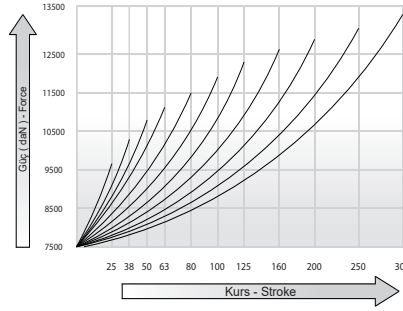
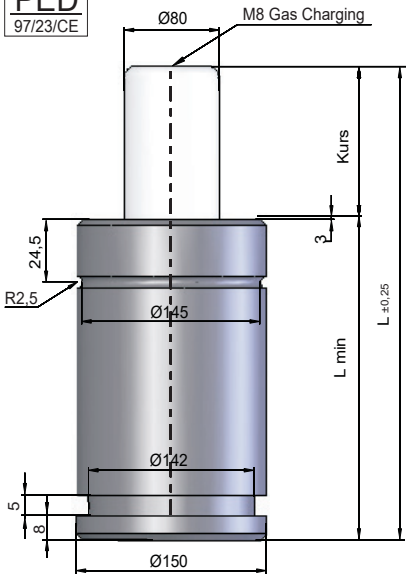
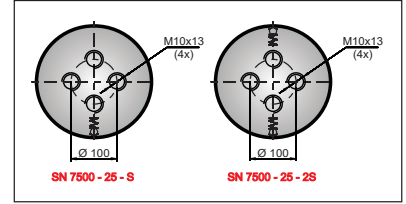
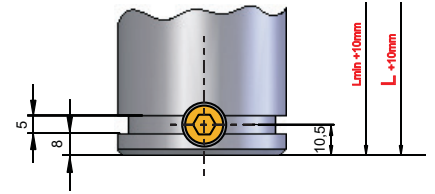

PED  
 97/23/CE

 ISO  
 11901-1

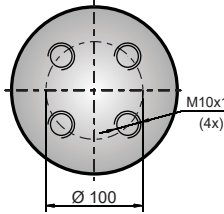
Basınç Gazı : Nitrogen N2  
 Pressuré Gas  
 Max. Basınç : 150 bar  
 Max. load pressure  
 Min. Basınç : 25 bar  
 Min. load pressure  
 Çalışma Sıcaklığı : 0°C ve +80°C  
 Working Temperature  
 Max Çalışma Hızı : 1,8 m / s  
 Max. operating speed

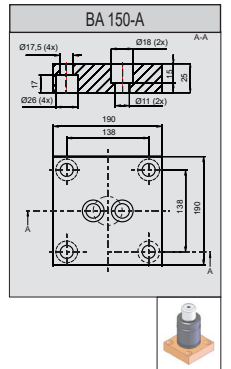
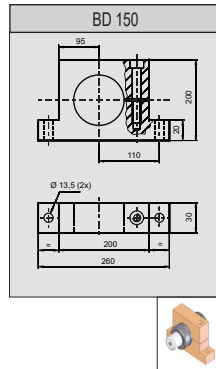
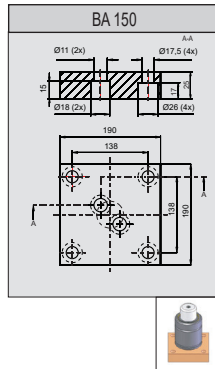
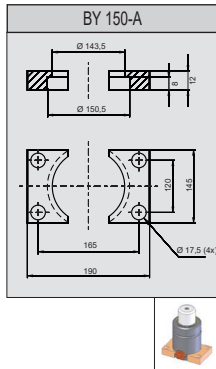
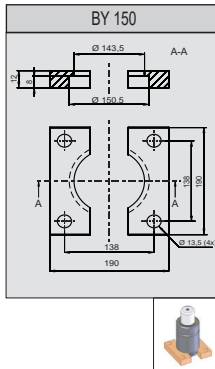
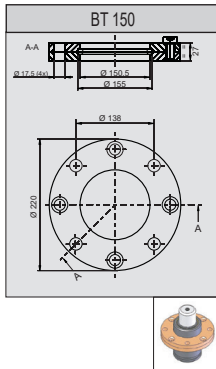
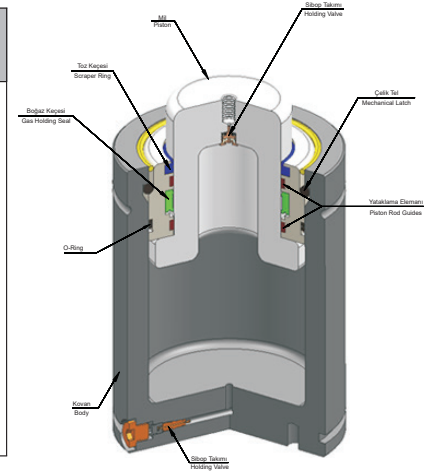
Kod Code	Kurs Stroke	L	Lmin	daN	Kg	Alt Görünüm Bottom View
SN 7500-25	25	205	180	5000	~ 19,8	
SN 7500-38	38	231	193		~ 21,0	
SN 7500-50	50	255	205		~ 21,8	
SN 7500-63	63	282	218,5		~ 22,6	
SN 7500-80	80	315	235		~ 24,4	
SN 7500-100	100	355	255		~ 26,1	
SN 7500-125	125	405	280		~ 28,0	
SN 7500-160	160	475	315		~ 31,4	
SN 7500-200	200	555	355		~ 35,0	
SN 7500-250	250	655	405		~ 38,5	
SN 7500-300	300	755	455	~ 42,4		

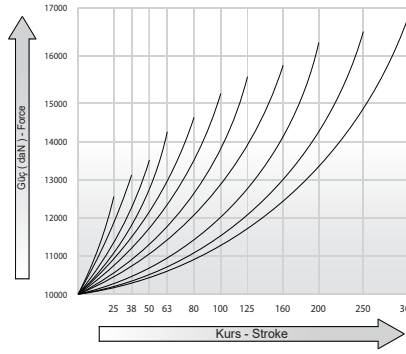
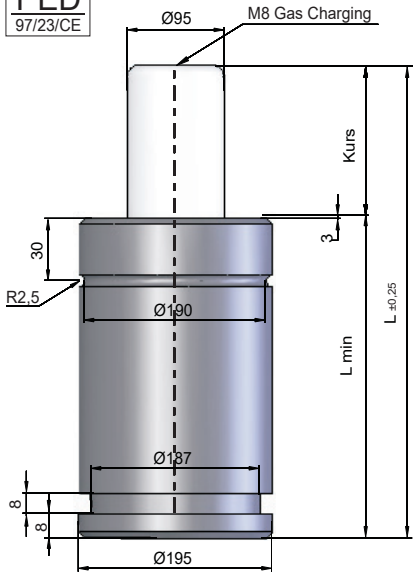
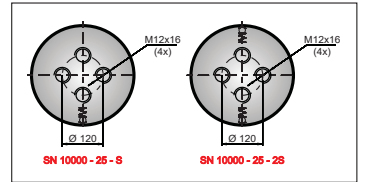
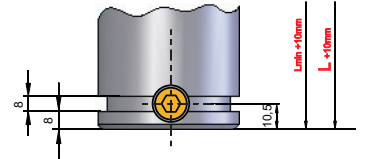

**PED**  
 97/23/CE

**ISO**  
 11901-1

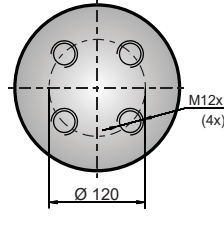
Basınç Gazı / Pressurè Gas : **Nitrogen N2**  
 Max. Basınç / Max. load pressure : **150 bar**  
 Min. Basınç / Min. load pressure : **25 bar**  
 Çalışma Sıcaklığı / Working Temperature : **0°C ve +80°C**  
 Max Çalışma Hızı / Max. operating speed : **1,8 m / s**

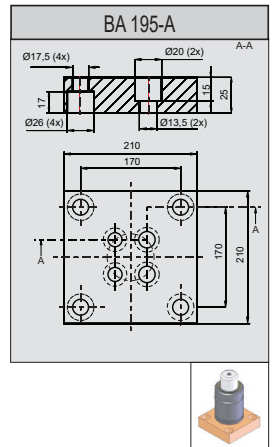
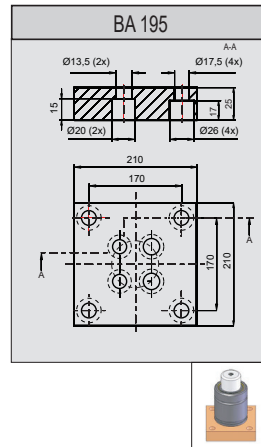
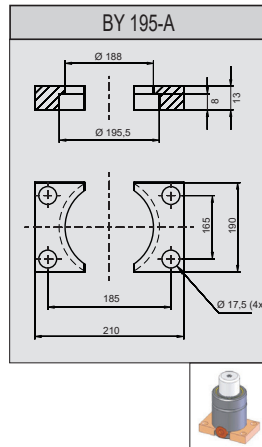
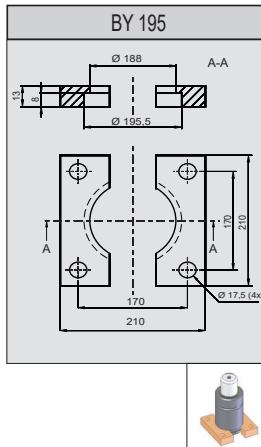
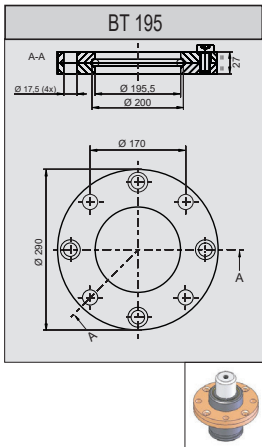
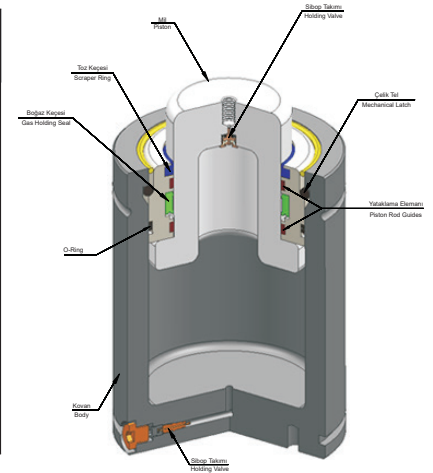
Kod Code	Kurs Stroke	L	Lmin	daN	Kg	Alt Görünüm Bottom View
SN 10000-25	25	210	185	<b>10000</b>	~ 34,8	
SN 10000-38	38	236	198		~ 36,7	
SN 10000-50	50	260	210		~ 38,5	
SN 10000-63	63	287	223,5		~ 40,5	
SN 10000-80	80	320	240		~ 43,0	
SN 10000-100	100	360	260		~ 46,0	
SN 10000-125	125	410	285		~ 49,8	
SN 10000-160	160	480	320		~ 55,0	
SN 10000-200	200	560	360		~ 61,0	
SN 10000-250	250	660	410		~ 68,5	
SN 10000-300	300	760	460	~ 76,0		



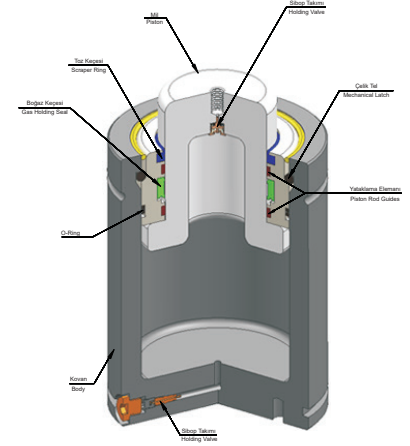
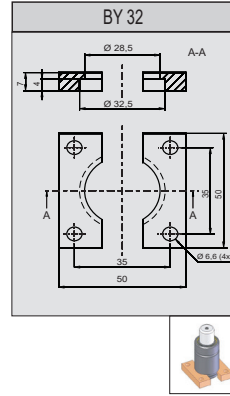
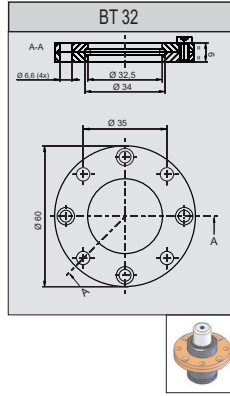
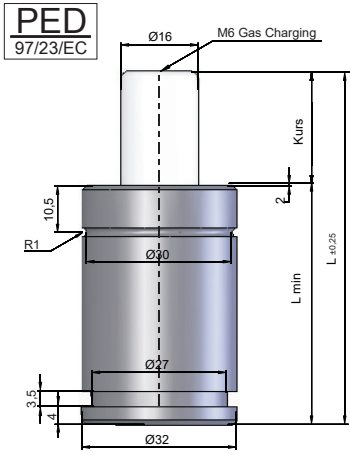



Basınç Gazı  
Pressure Gas

Max. Basınç  
Max. load pressure

Min. Basınç  
Min. load pressure

: Nitrogen N<sub>2</sub>

: 150 bar

: 25 bar



Çalışma Sıcaklığı  
Working Temperature

Max Çalışma Hızı  
Max. operating speed

: 0°C ve +80°C

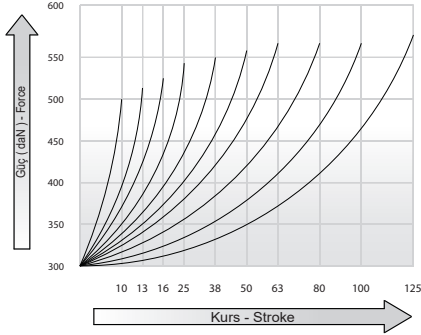
: 1,8 m / s

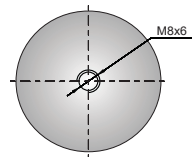

Kod Code	Kurs Stroke	L	Lmin			Alt Görünüm Bottom View
Y 300-10	10	70	60	250	~ 0,29	
Y 300-13	13	75,4	62,7		~ 0,30	
Y 300-16	16	82	66		~ 0,31	
Y 300-25	25	100	75		~ 0,34	
Y 300-38	38	126	88		~ 0,38	
Y 300-50	50	150	100		~ 0,43	
Y 300-63	63	177	113,5		~ 0,48	
Y 300-80	80	210	130		~ 0,54	
Y 300-100	100	250	150		~ 0,61	
Y 300-125	125	300	175		~ 0,69	

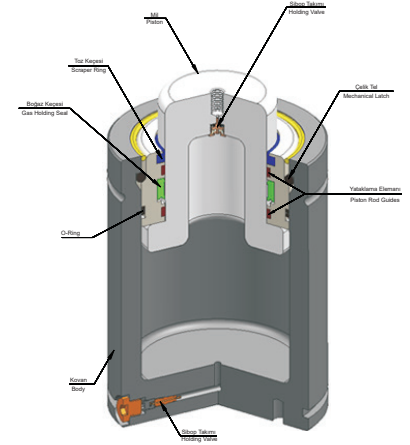
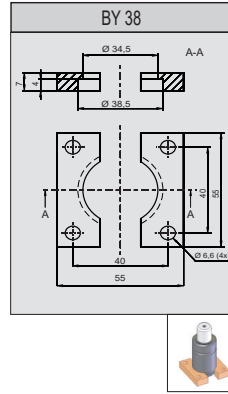
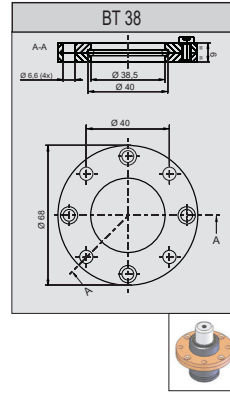
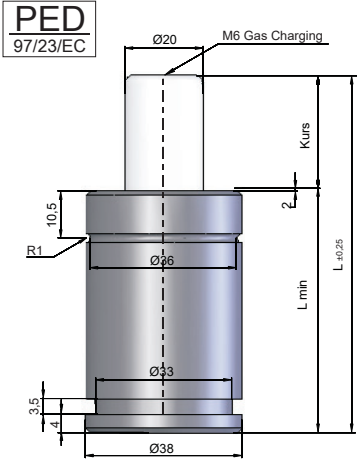

Basınç Gazı  
Pressure Gas

Max. Basınç  
Max. load pressure

Min. Basınç  
Min. load pressure

: Nitrogen N<sub>2</sub>

: 150 bar

: 25 bar



Çalışma Sıcaklığı  
Working Temperature

Max Çalışma Hızı  
Max. operating speed

: 0°C ve +80°C

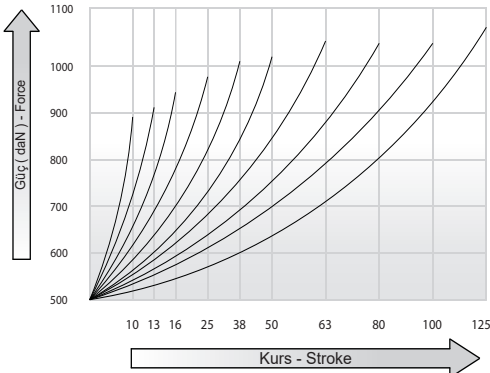
: 1,8 m / s

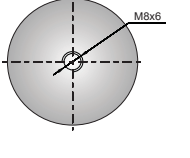

Kod Code	Kurs Stroke	L	Lmin			Alt Görünüm Bottom View
Y 500-10	10	70	60	250	~ 0,29	
Y 500-13	13	75,4	62,7		~ 0,30	
Y 500-16	16	82	66		~ 0,31	
Y 500-25	25	100	75		~ 0,34	
Y 500-38	38	126	88		~ 0,38	
Y 500-50	50	150	100		~ 0,43	
Y 500-63	63	177	113,5		~ 0,48	
Y 500-80	80	210	130		~ 0,54	
Y 500-100	100	250	150		~ 0,61	
Y 500-125	125	300	175		~ 0,69	

PED  
97/23/CE

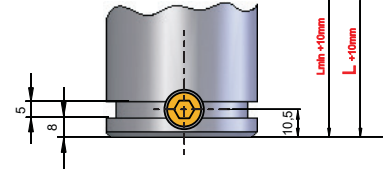
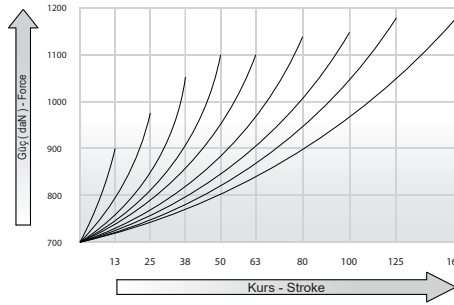
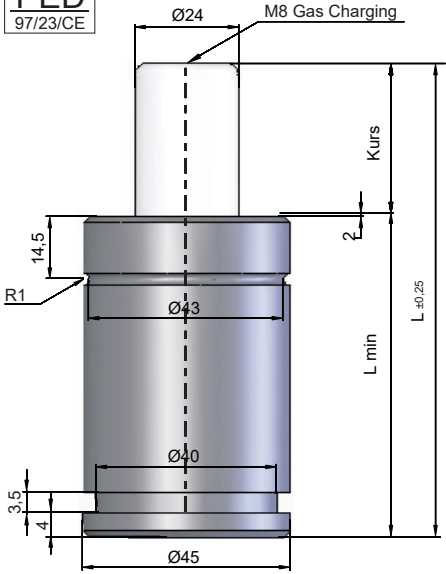

Basınç Gazı / Pressure Gas : Nitrogen N2  
 Max. Basınç / Max. load pressure : 150 bar  
 Min. Basınç / Min. load pressure : 25 bar  
 Çalışma Sıcaklığı / Working Temperature : 0°C ve +80°C  
 Max Çalışma Hızı / Max. operating speed : 1,8 m / s

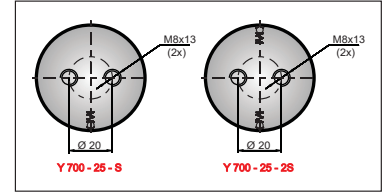

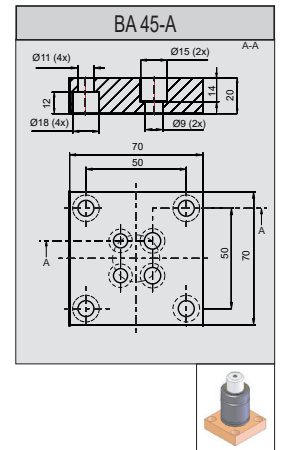
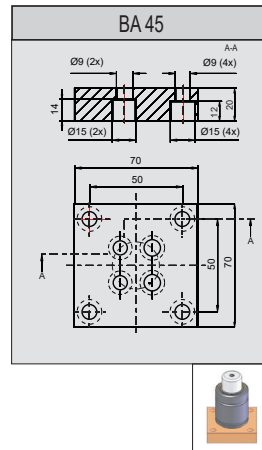
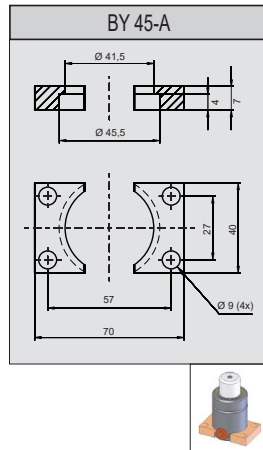
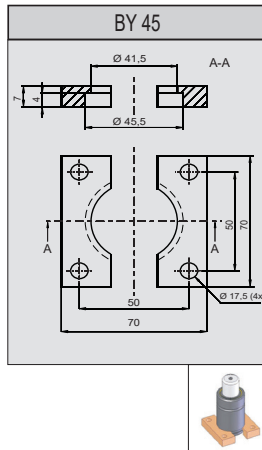
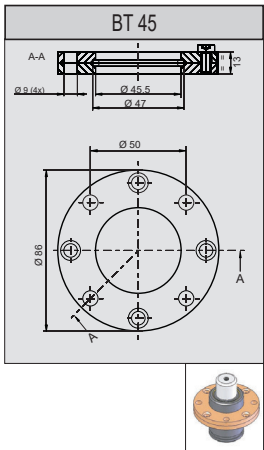
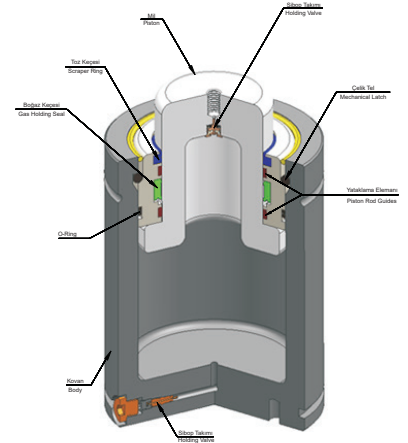

Kod Code	Kurs Stroke	L	Lmin	daN	Kg	Alt Görünüm Bottom View
Y 700-13	13	110,4	97,7	700	~ 0,98	
Y 700-25	25	135	110		~ 1,07	
Y 700-38	38	161	123		~ 1,16	
Y 700-50	50	185	135		~ 1,25	
Y 700-63	63	212	148,5		~ 1,35	
Y 700-80	80	245	165		~ 1,47	
Y 700-100	100	285	185		~ 1,72	
Y 700-125	125	335	210		~ 1,80	
Y 700-160	160	405	245	~ 2,05		

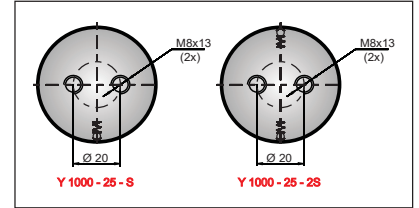
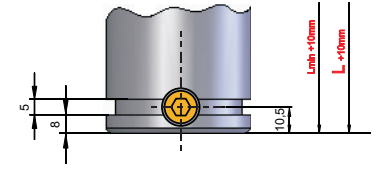
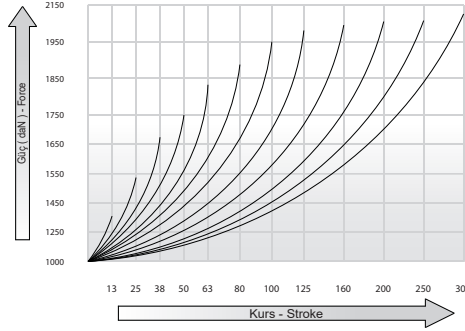
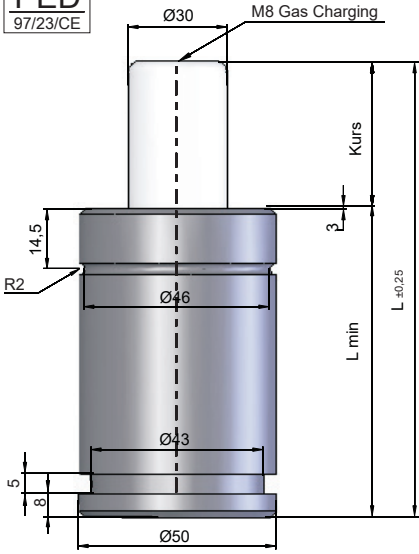

**PED**  
 97/23/CE

Basınç Gazı : Nitrogen N2  
 Pressure Gas  
 Max. Basınç : 150 bar  
 Max. load pressure  
 Min. Basınç : 25 bar  
 Min. load pressure  
 Çalışma Sıcaklığı : 0°C ve +80°C  
 Working Temperature  
 Max Çalışma Hızı : 1,8 m / s  
 Max. operating speed

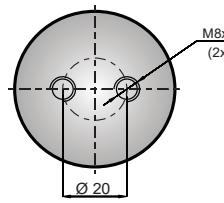
Kod Code	Kurs Stroke	L	Lmin	 daN	 Kg	Alt Görünüm Bottom View
Y1000-13	13	120,4	107,7		~ 1,35	
Y1000-25	25	145	120		~ 1,44	
Y1000-38	38	171	133		~ 1,59	
Y1000-50	50	195	145		~ 1,68	
Y1000-63	63	222	158,5		~ 1,83	
Y1000-80	80	255	175	<b>1000</b>	~ 1,99	
Y1000-100	100	295	195		~ 2,19	
Y1000-125	125	345	220		~ 2,43	
Y1000-160	160	415	255		~ 2,77	
Y1000-200	200	495	295		~ 3,16	
Y1000-250	250	595	345		~ 3,64	
Y1000-300	300	695	395		~ 4,13	

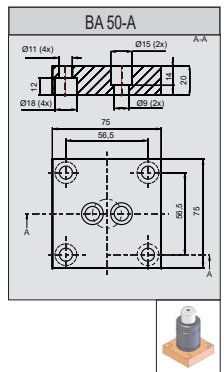
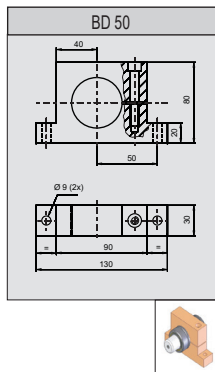
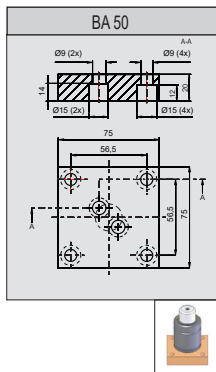
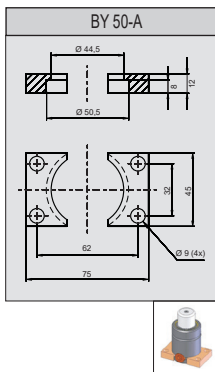
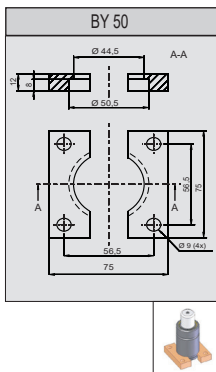
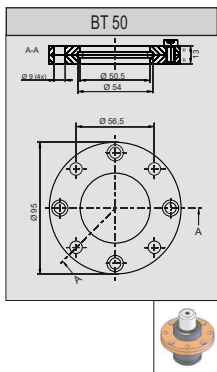
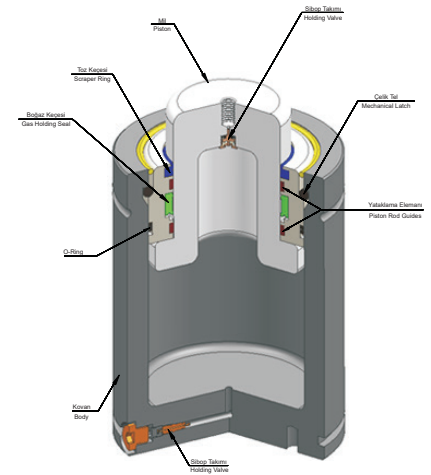

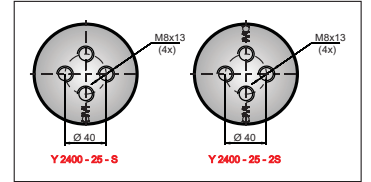
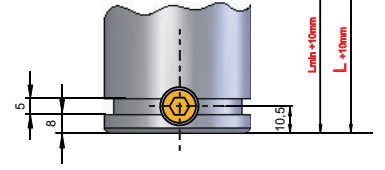
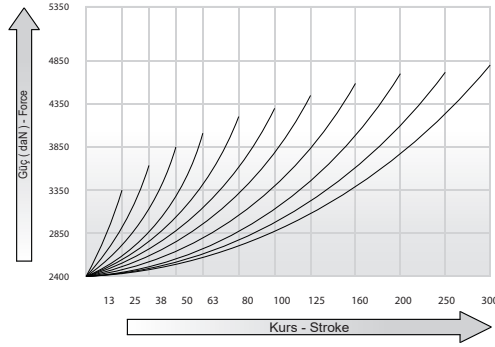
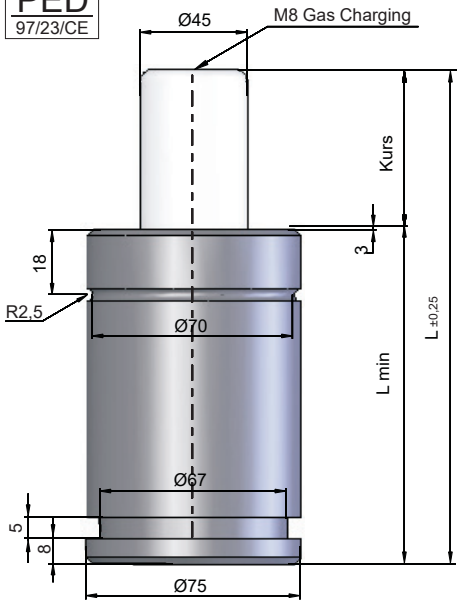
**PED**  
 97/23/CE

Basınç Gazı : Nitrogen N2  
 Pressure Gas  
 Max. Basınç : 150 bar  
 Max. load pressure  
 Min. Basınç : 25 bar  
 Min. load pressure  
 Çalışma Sıcaklığı : 0°C ve +80°C  
 Working Temperature  
 Max Çalışma Hızı : 1,8 m / s  
 Max. operating speed

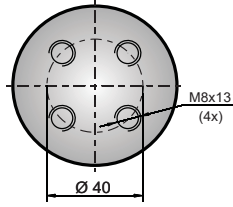
Kod Code	Kurs Stroke	L	Lmin	daN	Kg	Alt Görünüm Bottom View
Y 2400-25	25	160	135	2400	~ 3,70	
Y 2400-38	38	186	148		~ 3,96	
Y 2400-50	50	210	160		~ 4,21	
Y 2400-63	63	237	173,5		~ 4,50	
Y 2400-80	80	270	190		~ 4,81	
Y 2400-100	100	310	210		~ 5,23	
Y 2400-125	125	360	235		~ 5,67	
Y 2400-160	160	430	270		~ 6,48	
Y 2400-200	200	510	310		~ 7,49	
Y 2400-250	250	610	360		~ 9,36	
Y 2400-300	300	710	410	~ 11,23		

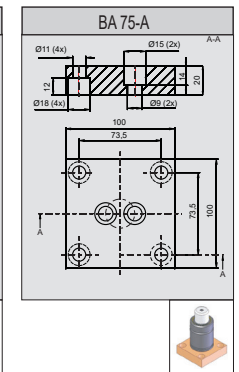
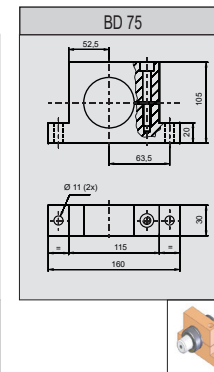
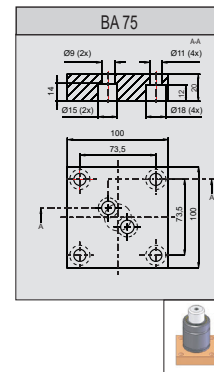
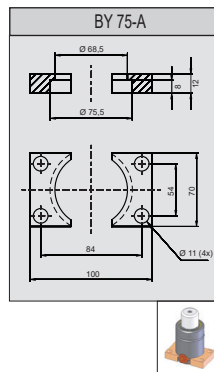
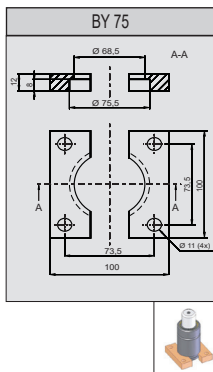
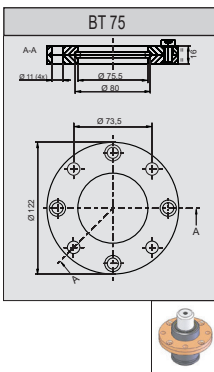
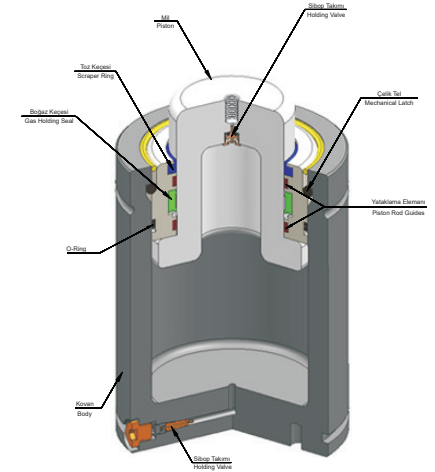

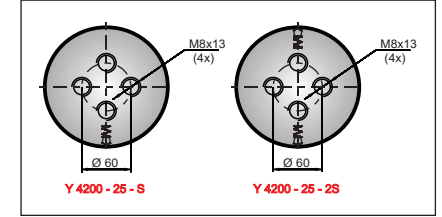
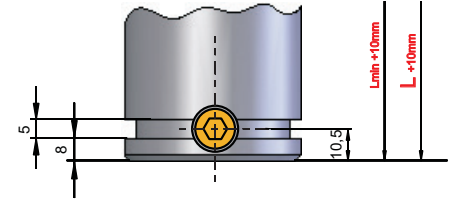
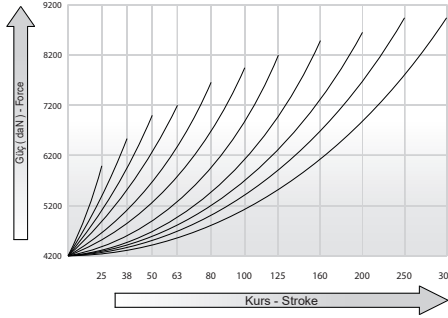
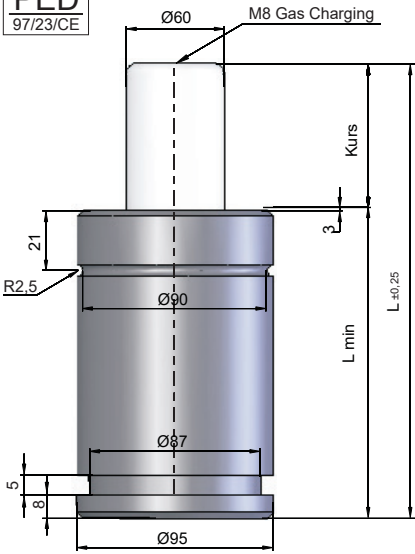
PED  
 97/23/CE

Basınç Gazı : Nitrogen N2  
 Pressure Gas  
 Max. Basınç : 150 bar  
 Max. load pressure  
 Min. Basınç : 25 bar  
 Min. load pressure  
 Çalışma Sıcaklığı : 0°C ve +80°C  
 Working Temperature  
 Max Çalışma Hızı : 1,8 m / s  
 Max. operating speed

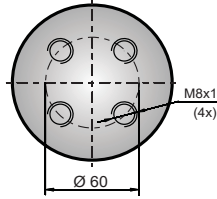
Kod Code	Kurs Stroke	L	Lmin	daN	Kg	Alt Görünüm Bottom View
Y 4200-25	25	170	145	4200	~ 6,54	
Y 4200-38	38	196	158		~ 7,00	
Y 4200-50	50	220	170		~ 7,37	
Y 4200-63	63	247	183,5		~ 7,84	
Y 4200-80	80	280	200		~ 8,35	
Y 4200-100	100	320	220		~ 9,30	
Y 4200-125	125	370	245		~ 9,80	
Y 4200-160	160	440	280		~ 10,5	
Y 4200-200	200	520	320		~ 11,3	
Y 4200-250	250	620	370		~ 12,3	
Y 4200-300	300	720	420	~ 13,3		

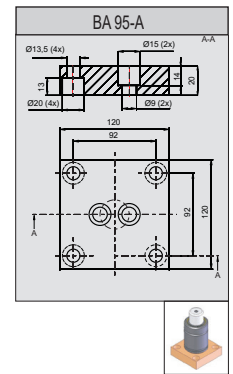
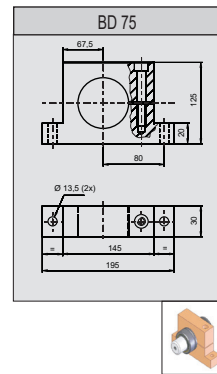
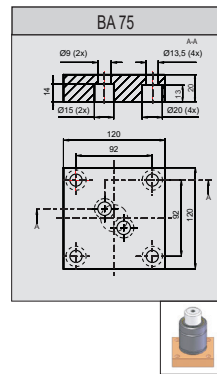
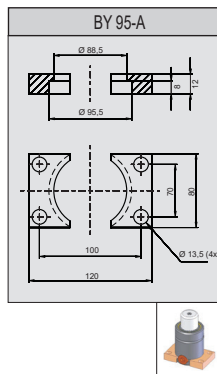
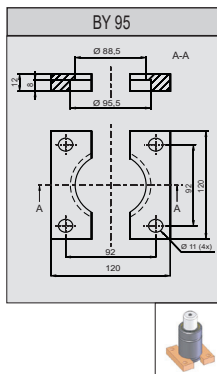
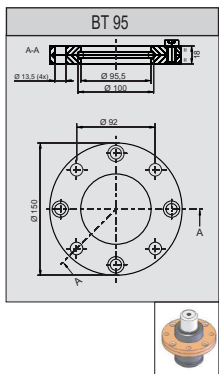
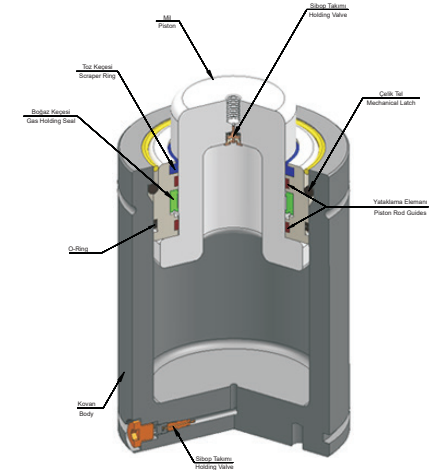

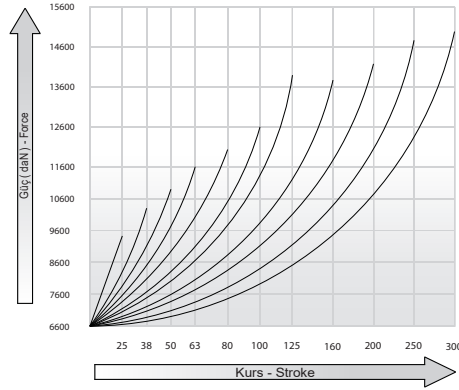
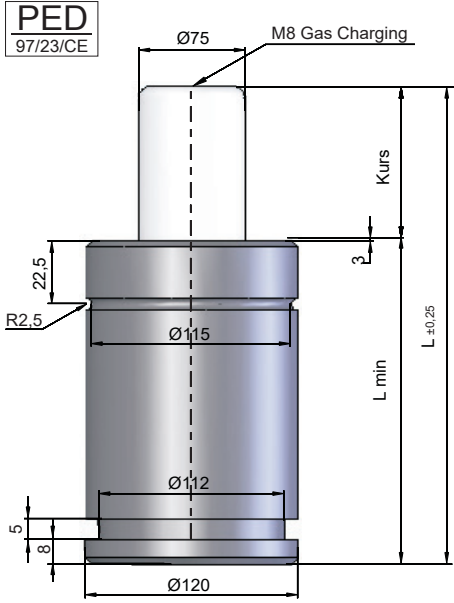

Basınç Gazı : Nitrogen N2  
 Pressure Gas  
 Max. Basınç : 150 bar  
 Max. load pressure  
 Min. Basınç : 25 bar  
 Min. load pressure  
 Çalışma Sıcaklığı : 0°C ve +80°C  
 Working Temperature  
 Max Çalışma Hızı : 1,8 m / s  
 Max. operating speed

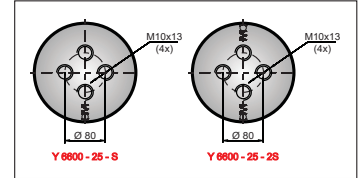
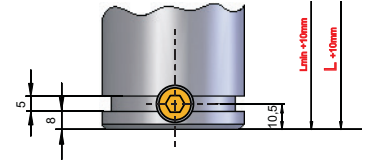

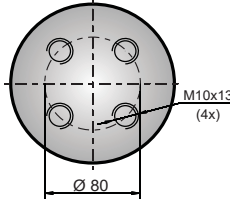
Kod Code	Kurs Stroke	L	Lmin	daN	Kg	Alt Görünüm Bottom View
Y 6600-25	25	190	165	6600	~ 12,1	
Y 6600-38	38	216	178		~ 13,7	
Y 6600-50	50	240	190		~ 15,1	
Y 6600-63	63	267	203,5		~ 15,5	
Y 6600-80	80	300	220		~ 16,1	
Y 6600-100	100	340	240		~ 17,5	
Y 6600-125	125	390	265		~ 19,3	
Y 6600-160	160	460	300		~ 21,8	
Y 6600-200	200	540	340		~ 24,7	
Y 6600-250	250	640	390		~ 28,3	
Y 6600-300	300	740	440	~ 31,9		

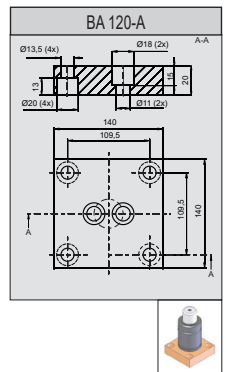
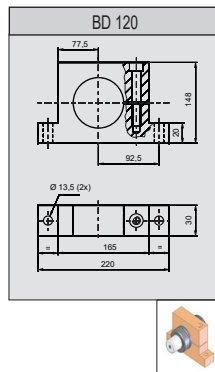
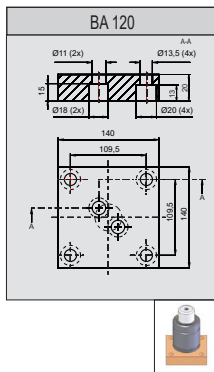
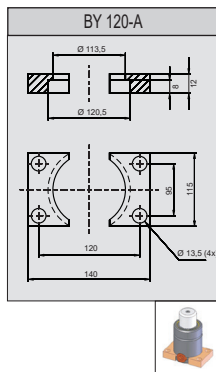
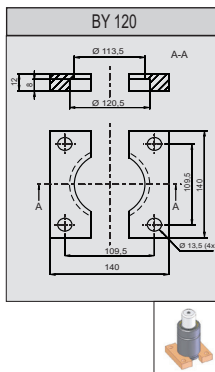
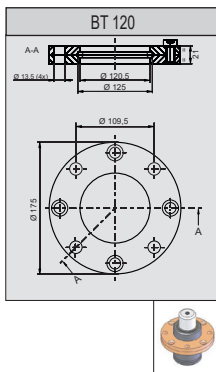
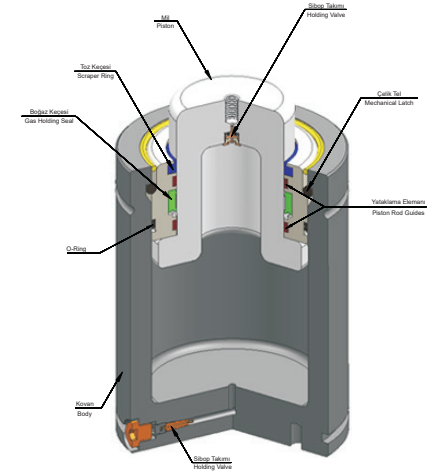

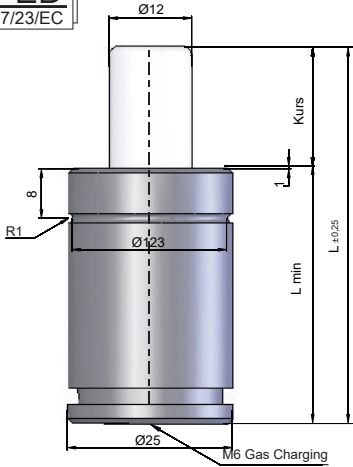
PED  
 97/23/EC

Basınç Gazı : Nitrogen N2  
 Pressure Gas  
 Max. Basınç : 150 bar  
 Max. load pressure  
 Min. Basınç : 25 bar  
 Min. load pressure  
 Çalışma Sıcaklığı : 0°C ve +80°C  
 Working Temperature  
 Max Çalışma Hızı : 1,8 m / s  
 Max. operating speed

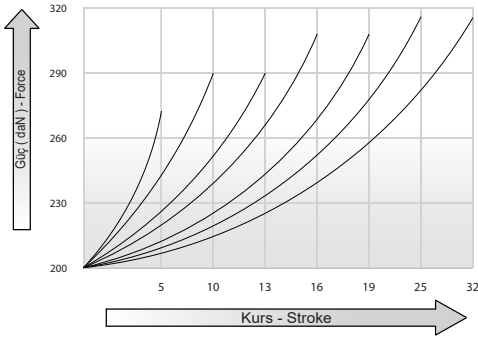
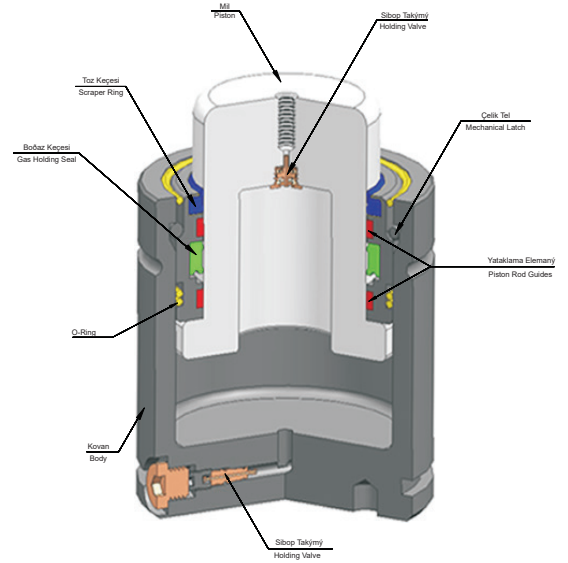

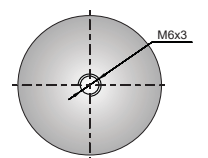
Kod Code	Kurs Stroke	L	Lmin	daN	Kg	Alt Görünüm Bottom View
YO 200-5	5	40	35	200	~ 0,09	
YO 200-10	10	50	40		~ 0,10	
YO 200-13	13	56	43		~ 0,10	
YO 200-16	16	62	46		~ 0,11	
YO 200-19	19	68	49		~ 0,12	
YO 200-25	25	80	55		~ 0,13	
YO 200-32	32	94	62		~ 0,16	

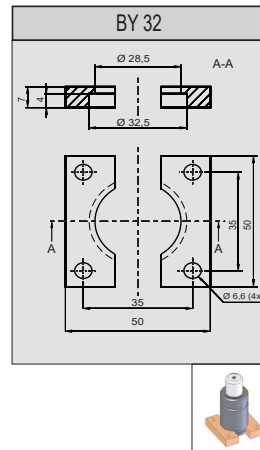
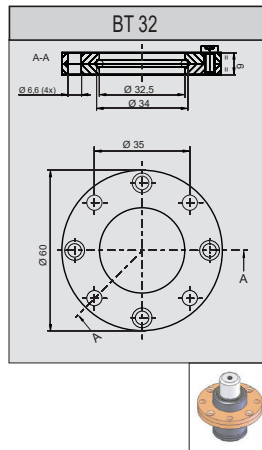
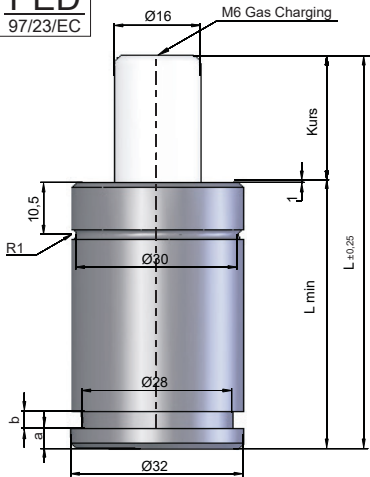
 PED  
 97/23/EC

Basınç Gazı : Nitrogen N2  
 Pressure Gas  
 Max. Basınç : 150 bar  
 Max. load pressure  
 Min. Basınç : 25 bar  
 Min. load pressure  
 Çalışma Sıcaklığı : 0°C ve +80°C  
 Working Temperature  
 Max Çalışma Hızı : 1,8 m / s  
 Max. operating speed

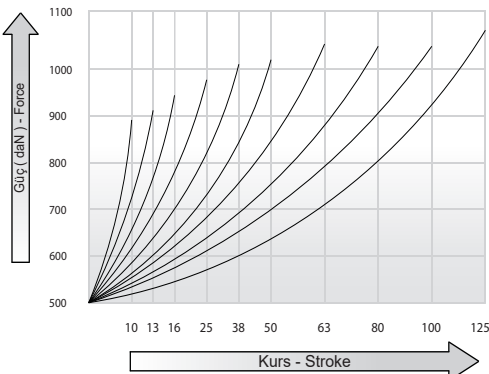
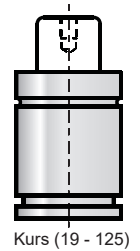
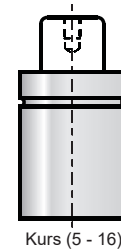

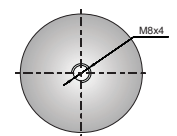
Kod Code	Kurs Stroke	L	Lmin	a	b	daN	Kg	Alt Görünüm Bottom View
YO 300-5	5	40	35	---	---	300	~ 0,17	
YO 300-10	10	50	40	---	---		~ 0,18	
YO 300-13	13	56	43	---	---		~ 0,19	
YO 300-16	16	62	46	---	---		~ 0,20	
YO 300-19	19	68	49	4	3,5		~ 0,22	
YO 300-25	25	80	55	4	3,5		~ 0,25	
YO 300-32	32	94	62	4	3,5		~ 0,27	
YO 300-38	38	106	68	4	3,5		~ 0,29	
YO 300-50	50	130	80	4	3,5		~ 0,34	
YO 300-63	63	156	93	4	3,5		~ 0,39	
YO 300-75	75	180	105	4	3,5		~ 0,42	
YO 300-80	80	190	110	4	3,5		~ 0,45	
YO 300-100	100	230	130	4	3,5		~ 0,53	
YO 300-125	125	280	155	4	3,5		~ 0,68	

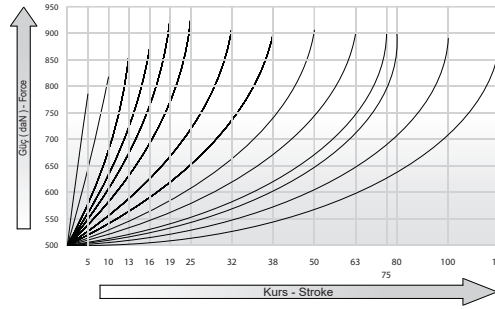
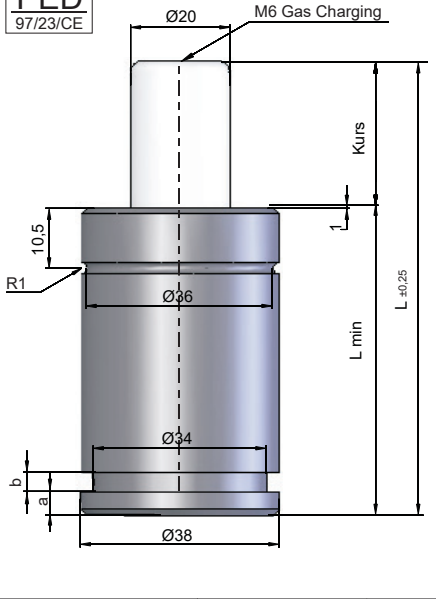
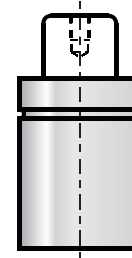
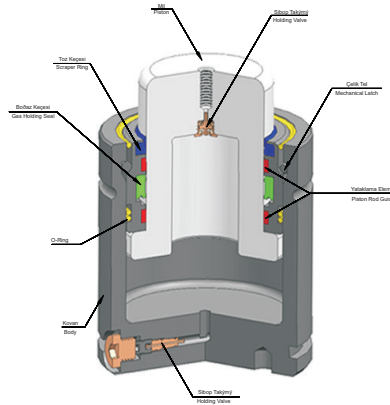
PED  
 97/23/CE

 Basınç Gazı : Nitrogen N2  
 Pressurè Gas  
 Max. Basınç : 150 bar  
 Max. load pressure  
 Min. Basınç : 25 bar  
 Min. load pressure  
 Çalışma Sıcaklığı : 0°C ve +80°C  
 Working Temperature  
 Max Çalışma Hızı : 1,8 m / s  
 Max. operating speed

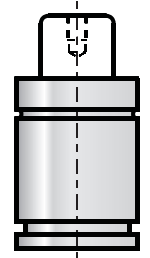
Kurs (5 - 16)

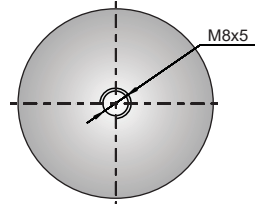

Kurs (19 - 125)

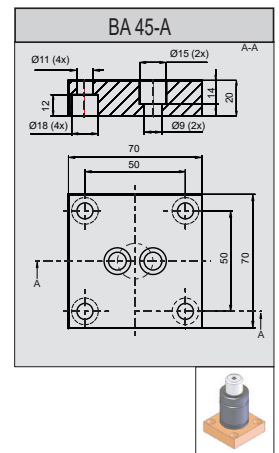
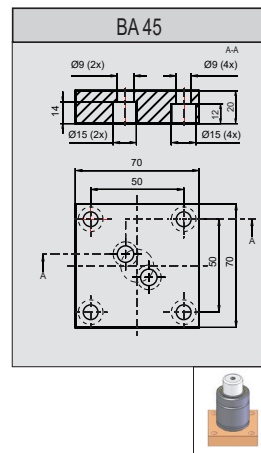
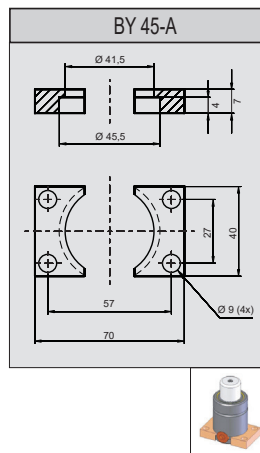
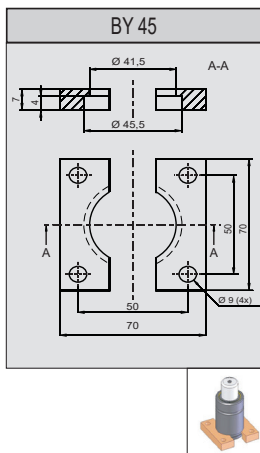
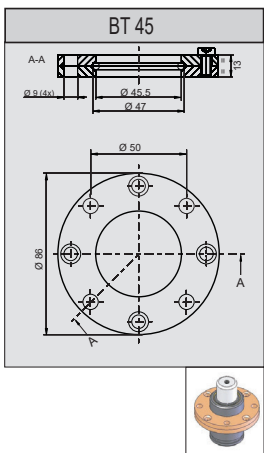
Kod Code	Kurs Stroke	L	Lmin	a	b	daN	Kg	Alt Görünüm Bottom View
YO 500-5	5	40	35	---	---	500	~ 0,25	
YO 500-10	10	50	40	---	---		~ 0,27	
YO 500-13	13	56	43	---	---		~ 0,29	
YO 500-16	16	62	46	---	---		~ 0,31	
YO 500-19	19	68	49	4	3,5		~ 0,33	
YO 500-25	25	80	55	4	3,5		~ 0,36	
YO 500-32	32	94	62	4	3,5		~ 0,40	
YO 500-38	38	106	68	4	3,5		~ 0,44	
YO 500-50	50	130	80	4	3,5		~ 0,50	
YO 500-63	63	156	93	4	3,5		~ 0,57	
YO 500-75	75	180	105	4	3,5		~ 0,61	
YO 500-80	80	190	110	4	3,5		~ 0,66	
YO 500-100	100	230	130	4	3,5		~ 0,77	
YO 500-125	125	280	155	4	3,5	~ 0,90		



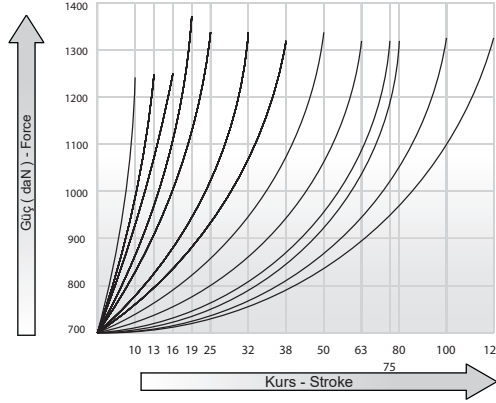
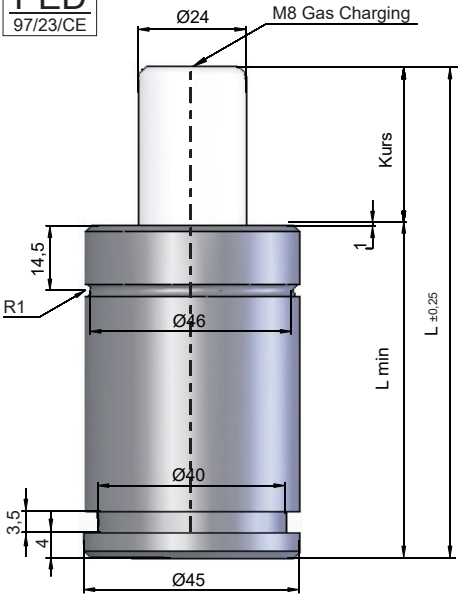
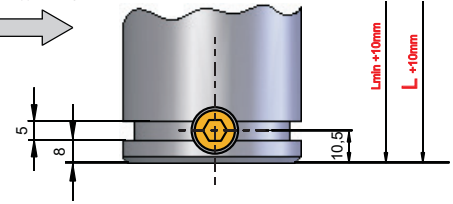
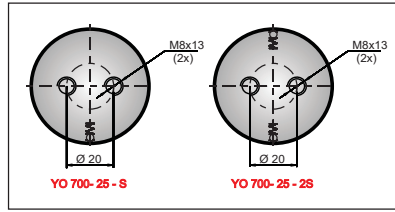

PED  
 97/23/CE

 Basınç Gazı : Nitrogen N2  
 Pressurè Gas  
 Max. Basınç : 150 bar  
 Max. load pressure  
 Min. Basınç : 25 bar  
 Min. load pressure  
 Çalışma Sıcaklığı : 0°C ve +80°C  
 Working Temperature  
 Max Çalışma Hızı : 1,8 m / s  
 Max. operating speed

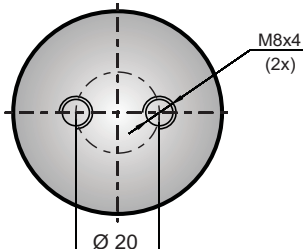
 Seri bağlanacak gazlı yaylarda  
 L ve Lmin ölçülerine +10 mm eklenecektir .  
 Sipariş için kodlama sonuna ( S ) eklenecektir .  
**YO 1000 - 25 - S**

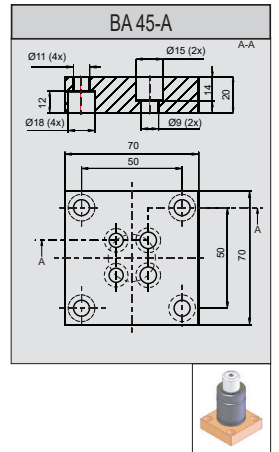
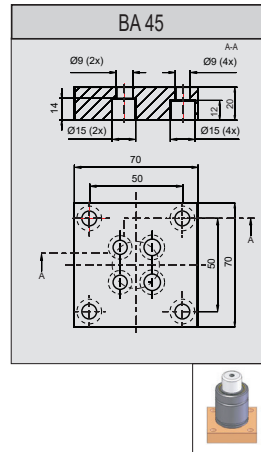
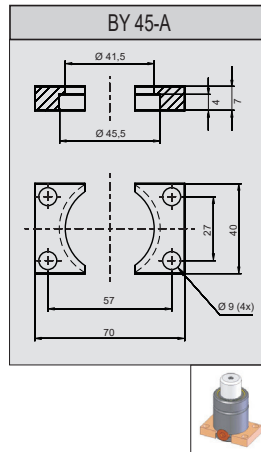
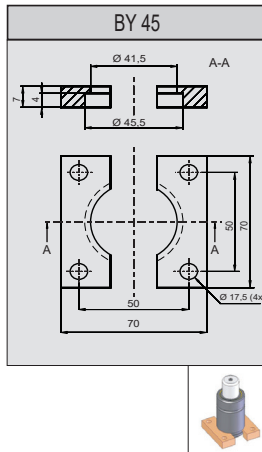
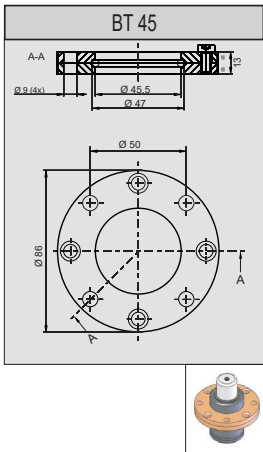

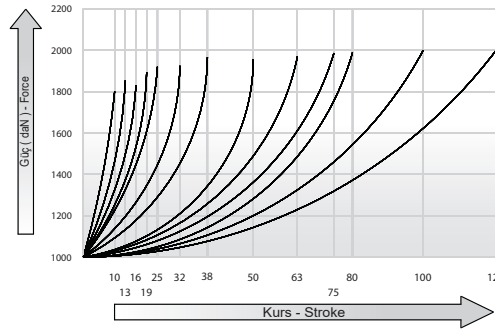
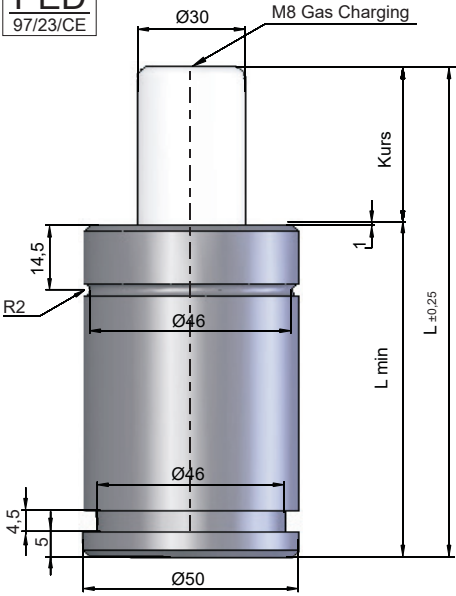
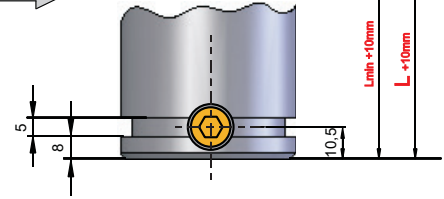
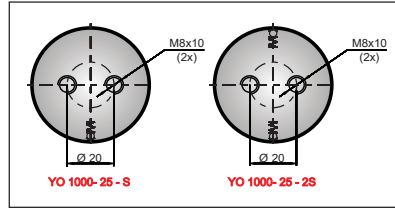
 For the Gas Springs to be connected serial  
 L and Lmin dimensions must be increased +10 mm.  
 For the Orders , you must add an ( S ) on the end.  
**YO 1000 - 25 - S**

Kod Code	Kurs Stroke	L	Lmin	daN	Kg	Alt Görünüm Bottom View
YO 700-10	10	52	42	700	~ 0,39	
YO 700-13	13	58	45		~ 0,42	
YO 700-16	16	64	48		~ 0,45	
YO 700-19	19	70	51		~ 0,48	
YO 700-25	25	82	57		~ 0,53	
YO 700-32	32	96	64		~ 0,58	
YO 700-38	38	108	70		~ 0,62	
YO 700-50	50	132	82		~ 0,71	
YO 700-63	63	158	95		~ 0,81	
YO 700-75	75	182	107		~ 0,85	
YO 700-80	80	192	112		~ 0,93	
YO 700-100	100	232	132		~ 1,04	
YO 700-125	125	282	157	~ 1,28		



PED  
 97/23/CE

 Basınç Gazı : Nitrogen N2  
 Pressure Gas  
 Max. Basınç : 150 bar  
 Max. load pressure  
 Min. Basınç : 25 bar  
 Min. load pressure  
 Çalışma Sıcaklığı : 0°C ve +80°C  
 Working Temperature  
 Max Çalışma Hızı : 1,8 m / s  
 Max. operating speed

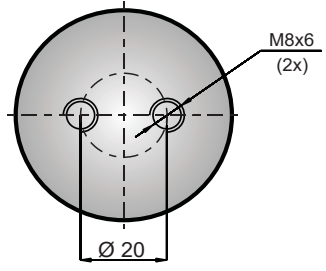
 Seri bağlanacak gazlı yaylarda  
 L ve Lmin ölçülerine +10 mm eklenecektir .  
 Sipariş için kodlama sonuna ( S ) eklenecektir .  
**YO 1000 - 25 - S**

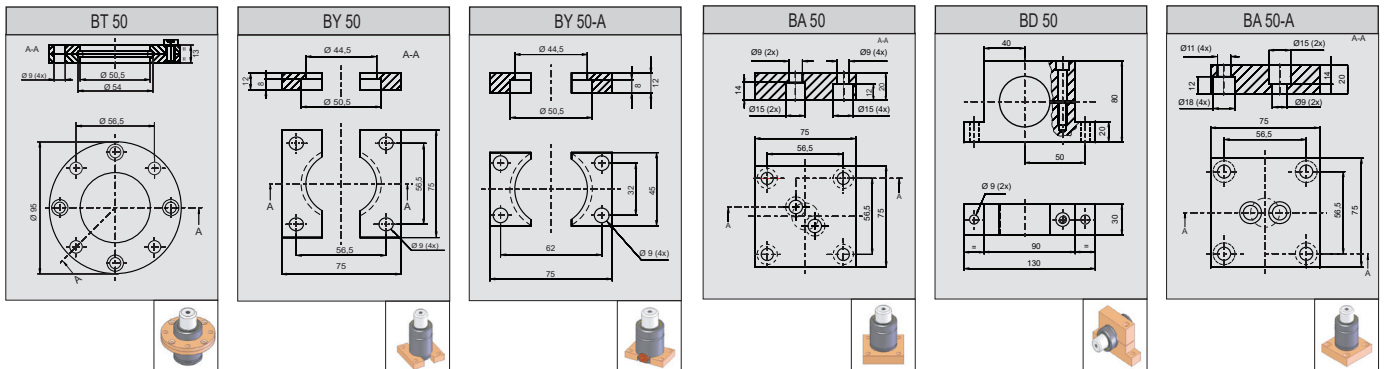
 For the Gas Springs to be connected serial  
 L and Lmin dimensions must be increased +10 mm.  
 For the Orders , you must add an ( S ) on the end.  
**YO 1000 - 25 - S**

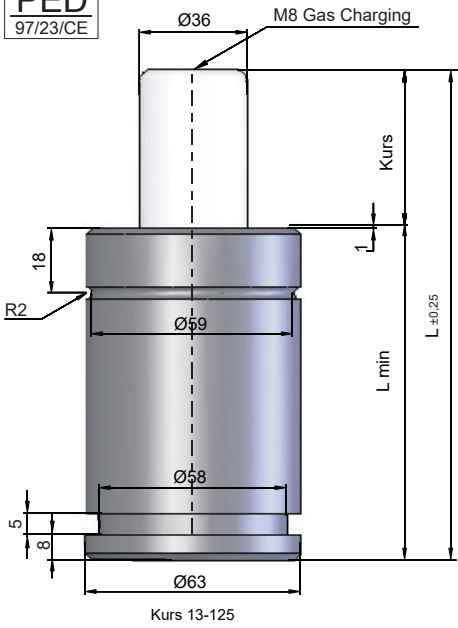
Kod Code	Kurs Stroke	L	Lmin	 daN	 Kg	Alt Görünüm Bottom View
YO 1000-10	10	58	48	1000	~ 0,57	
YO 1000-13	13	64	51		~ 0,59	
YO 1000-16	16	70	54		~ 0,62	
YO 1000-19	19	76	57		~ 0,65	
YO 1000-25	25	88	63		~ 0,70	
YO 1000-32	32	102	70		~ 0,77	
YO 1000-38	38	114	76		~ 0,83	
YO 1000-50	50	138	88		~ 0,94	
YO 1000-63	63	164	101		~ 1,07	
YO 1000-75	75	188	113		~ 1,16	
YO 1000-80	80	198	118		~ 1,21	
YO 1000-100	100	238	138		~ 1,43	
YO 1000-125	125	288	163		~ 1,70	



PED  
 97/23/CE

Kurs 13-125

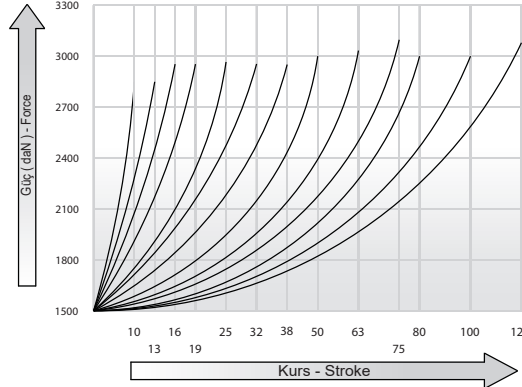
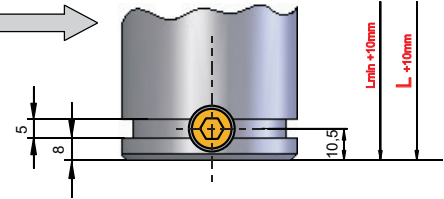
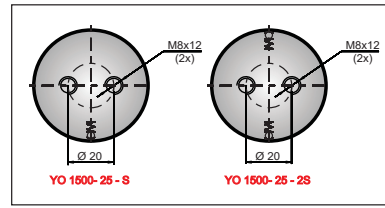
 Basınç Gazı : Nitrogen N2  
 Pressurè Gas  
 Max. Basınç : 150 bar  
 Max. load pressure  
 Min. Basınç : 25 bar  
 Min. load pressure  
 Çalışma Sıcaklığı : 0°C ve +80°C  
 Working Temperature  
 Max Çalışma Hızı : 1,8 m / s  
 Max. operating speed

 Seri bağlanacak gazlı yaylarda  
 L ve Lmin ölçülerine +10 mm eklenecektir .  
 Sipariş için kodlama sonuna ( S ) eklenecektir .  
**YO 1500 - 25 - S**

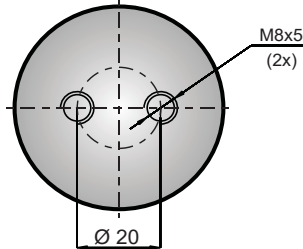
 For the Gas Springs to be connected serial  
 L and Lmin dimensions must be increased +10 mm.  
 For the Orders , you must add an ( S ) on the end.  
**YO 1500 - 25 - S**

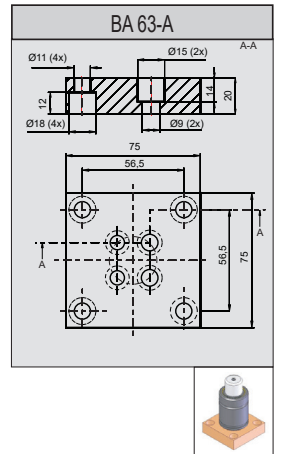
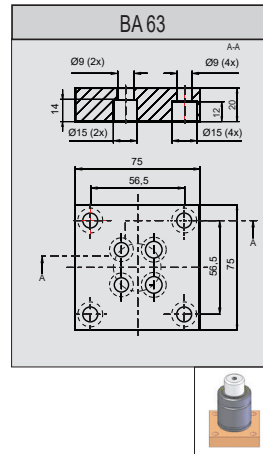
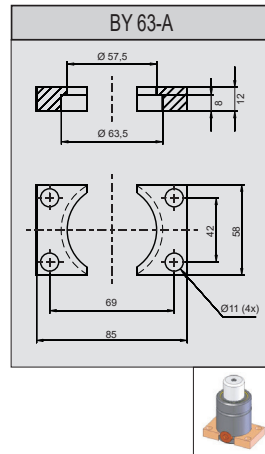
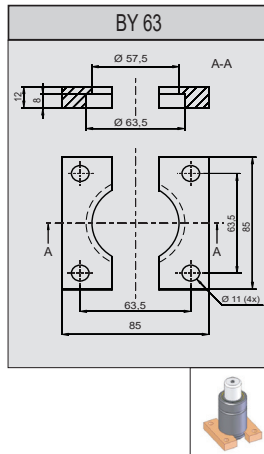
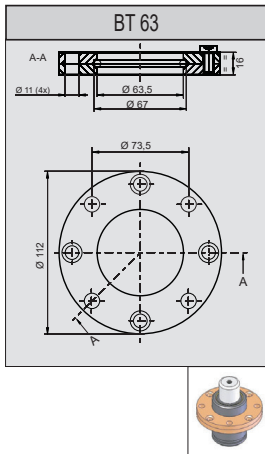
Kod Code	Kurs Stroke	L	Lmin	daN	Kg	Alt Görünüm Bottom View
YO 1500-10	10	64	54	1500	~ 1,02	
YO 1500-13	13	70	57		~ 1,05	
YO 1500-16	16	76	60		~ 1,10	
YO 1500-19	19	82	63		~ 1,15	
YO 1500-25	25	94	69		~ 1,25	
YO 1500-32	32	108	76		~ 1,35	
YO 1500-38	38	120	82		~ 1,44	
YO 1500-50	50	144	94		~ 1,61	
YO 1500-63	63	170	107		~ 1,81	
YO 1500-75	75	194	119		~ 1,90	
YO 1500-80	80	204	124		~ 2,06	
YO 1500-100	100	244	144		~ 2,38	
YO 1500-125	125	294	169	~ 2,86		

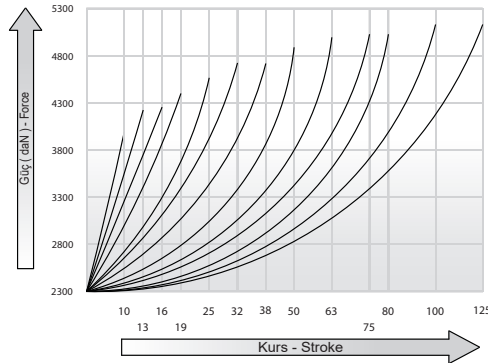
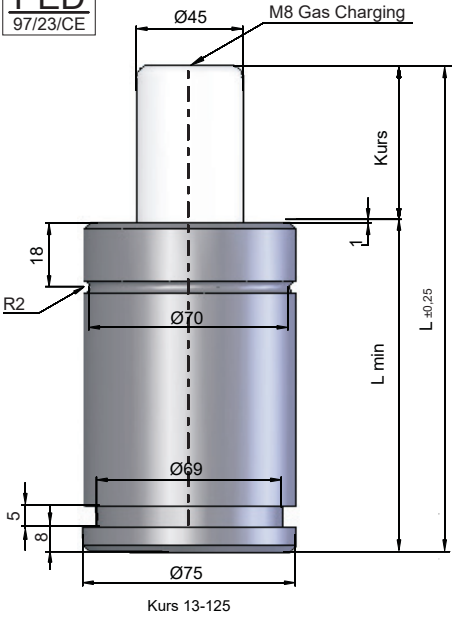

**PED**  
 97/23/CE

Basınç Gazı : Nitrogen N2  
 Pressure Gas  
 Max. Basınç : 150 bar  
 Max. load pressure  
 Min. Basınç : 25 bar  
 Min. load pressure  
 Çalışma Sıcaklığı : 0°C ve +80°C  
 Working Temperature  
 Max Çalışma Hızı : 1,8 m / s  
 Max. operating speed

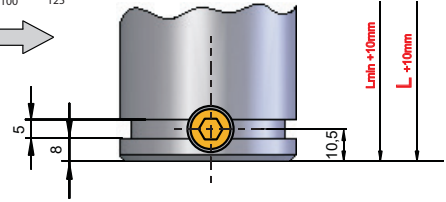
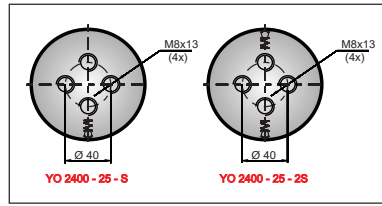

Seri bağlanacak gazlı yaylarda  
**L** ve **Lmin** ölçülerine **+10 mm** eklenecektir .  
 Sipariş için kodlama sonuna **(S)** eklenecektir .  
**YO 2400 - 25 - S**

For the Gas Springs to be connected serial  
**L** and **Lmin** dimensions must be increased **+10 mm**.  
 For the Orders , you must add an **(S)** on the end.  
**YO 2400 - 25 - S**

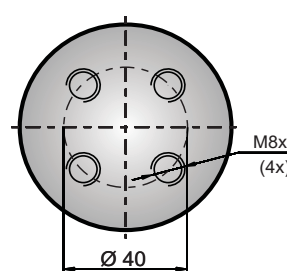
Kod Code	Kurs Stroke	L	Lmin	daN	Kg	Alt Görünüm Bottom View
YO 2400-10	10	65	55	1500	~ 1,47	
YO 2400-13	13	71	58		~ 1,52	
YO 2400-16	16	77	61		~ 1,58	
YO 2400-19	19	83	64		~ 1,65	
YO 2400-25	25	95	70		~ 1,77	
YO 2400-32	32	109	77		~ 1,93	
YO 2400-38	38	121	83		~ 2,05	
YO 2400-50	50	145	95		~ 2,30	
YO 2400-63	63	171	108		~ 2,55	
YO 2400-80	80	205	125		~ 2,85	
YO 2400-100	100	245	145		~ 3,28	
YO 2400-125	125	295	170		~ 3,93	

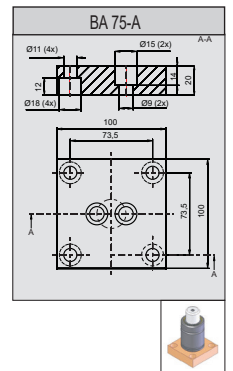
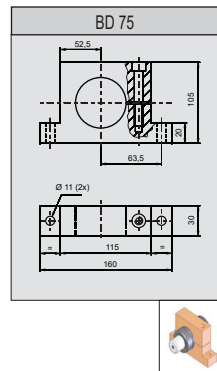
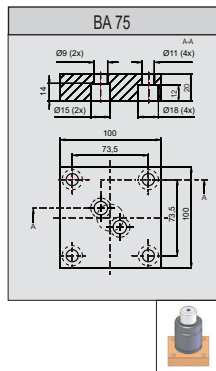
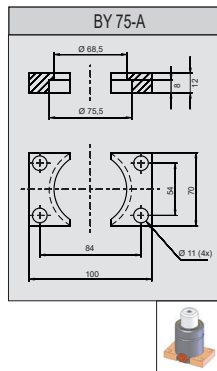
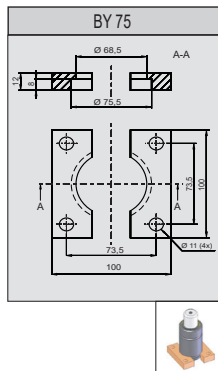
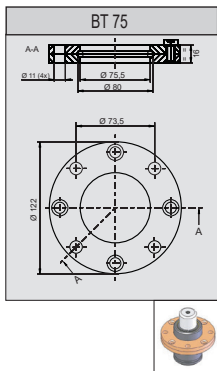

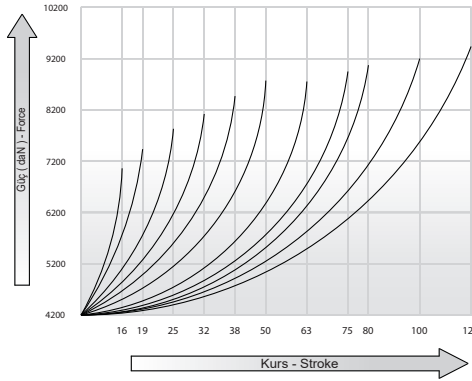
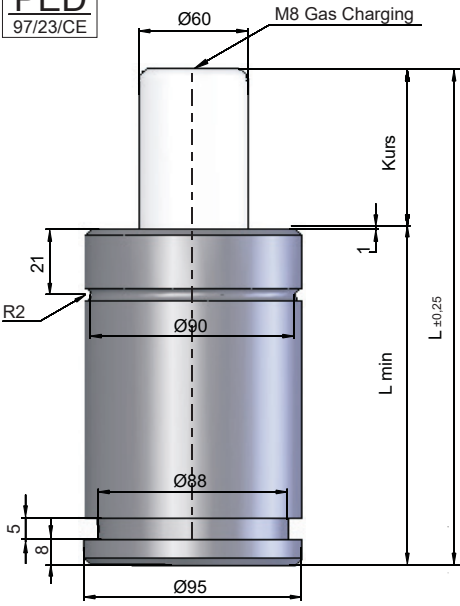
**PED**  
 97/23/CE

Basınç Gazı : Nitrogen N2  
 Pressure Gas  
 Max. Basınç : 150 bar  
 Max. load pressure  
 Min. Basınç : 25 bar  
 Min. load pressure  
 Çalışma Sıcaklığı : 0°C ve +80°C  
 Working Temperature  
 Max Çalışma Hızı : 1,8 m / s  
 Max. operating speed

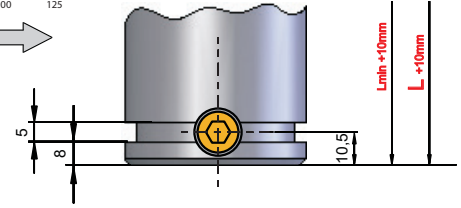
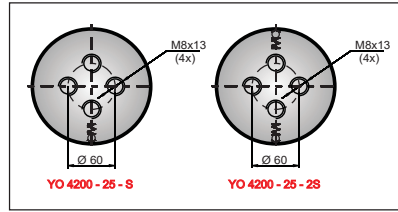

Seri bağlanacak gazlı yaylarda  
**L** ve **Lmin** ölçülerine **+10 mm** eklenecektir .  
 Sipariş için kodlarına sonuna **( S )** eklenecektir .  
**YO 4200 - 25 - S**

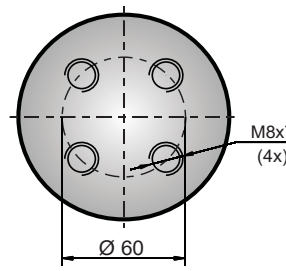

For the Gas Springs to be connected serial  
**L** and **Lmin** dimensions must be increased **+10 mm**.  
 For the Orders , you must add an **( S )** on the end.  
**YO 4200 - 25 - S**

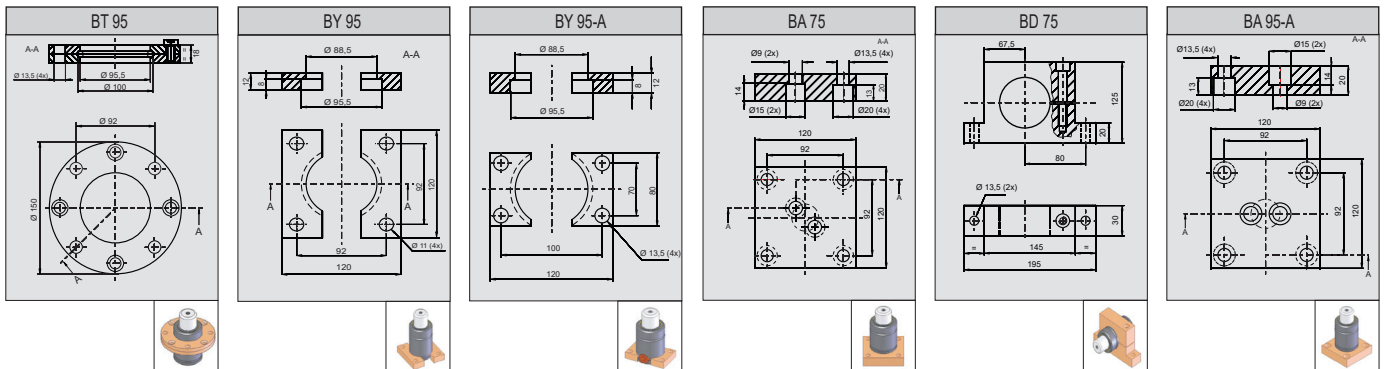
Kod Code	Kurs Stroke	L	Lmin	daN	Kg	Alt Görünüm Bottom View
YO 4200-16	16	97	81	4200	~ 3,40	
YO 4200-19	19	103	84		~ 3,45	
YO 2400-25	25	115	90		~ 3,65	
YO 4200-32	32	129	97		~ 3,82	
YO 4200-38	38	141	103		~ 4,00	
YO 4200-50	50	165	115		~ 4,44	
YO 4200-63	63	191	128		~ 4,95	
YO 4200-75	75	215	140		~ 5,20	
YO 4200-80	80	225	145		~ 5,41	
YO 4200-100	100	265	165		~ 6,00	
YO 4200-125	125	315	190		~ 6,70	

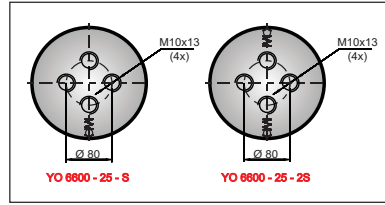
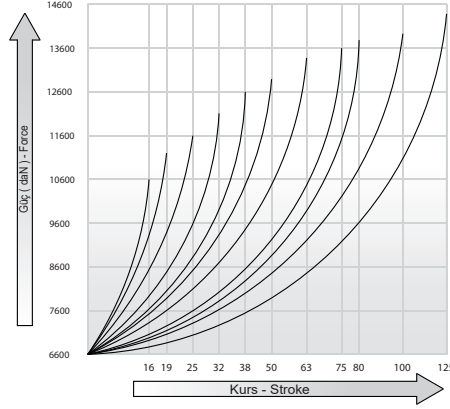
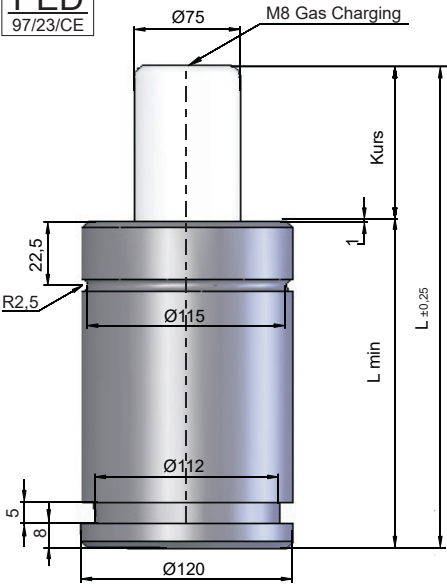
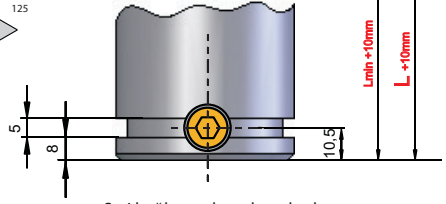

PED  
 97/23/CE

 Basınç Gazı : Nitrogen N2  
 Pressurè Gas  
 Max. Basınç : 150 bar  
 Max. load pressure  
 Min. Basınç : 25 bar  
 Min. load pressure  
 Çalışma Sıcaklığı : 0°C ve +80°C  
 Working Temperature  
 Max Çalışma Hızı : 1,8 m / s  
 Max. operating speed

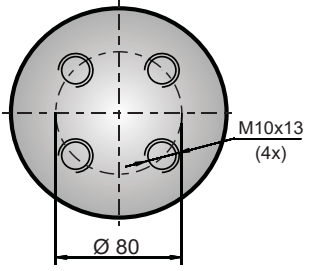
 Seri bağlanacak gazlı yaylarda  
 L ve Lmin ölçülerine +10 mm eklenecektir .  
 Sipariş için kodlama sonuna (S) eklenecektir .  
**YO 6600 - 25 - S**

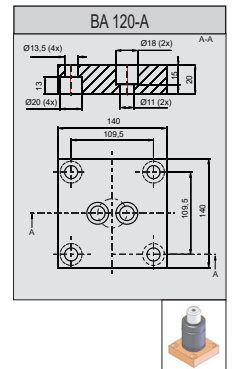
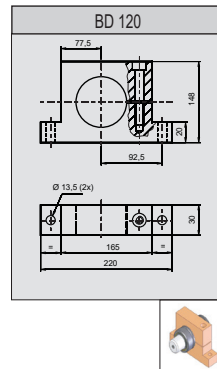
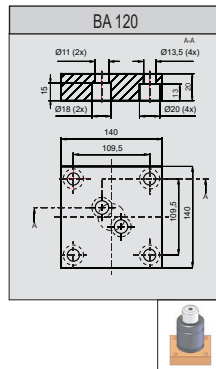
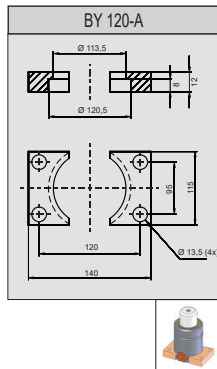
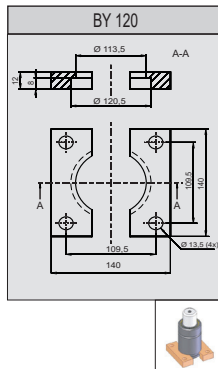
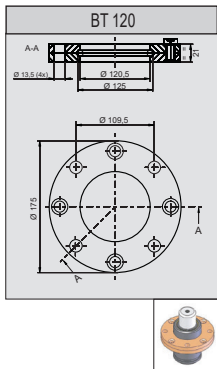
 For the Gas Springs to be connected serial  
 L and Lmin dimensions must be increased +10 mm.  
 For the Orders , you must add an (S) on the end.  
**YO 6600 - 25 - S**

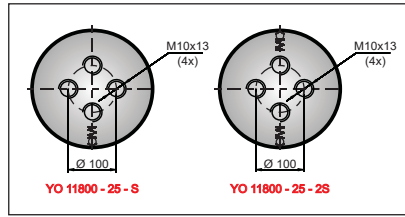
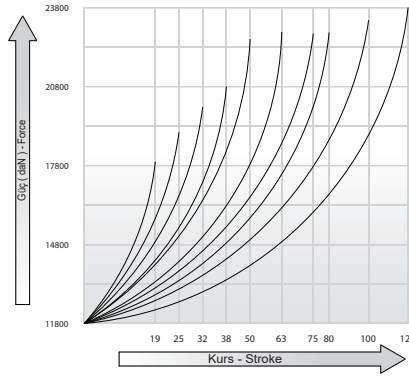
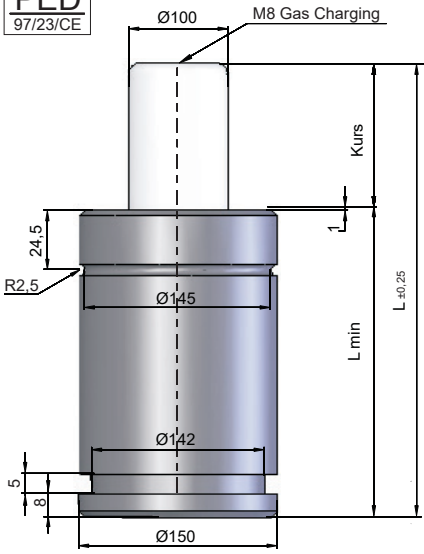
Kod Code	Kurs Stroke	L	Lmin	 daN	 Kg	Alt Görünüm Bottom View
YO 6600-16	16	107	91	6600	~ 6,60	
YO 6600-19	19	113	94		~ 6,65	
YO 6600-25	25	125	100		~ 6,82	
YO 6600-32	32	139	107		~ 7,18	
YO 6600-38	38	151	113		~ 7,57	
YO 6600-50	50	175	125		~ 8,18	
YO 6600-63	63	201	138		~ 8,81	
YO 6600-75	75	225	150		~ 8,95	
YO 6600-80	80	235	155		~ 9,10	
YO 6600-100	100	275	175		~ 10,7	
YO 6600-125	125	325	200	~ 12,5		



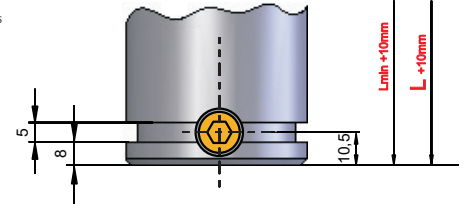

PED  
 97/23/CE

Basınç Gazı : Nitrogen N2  
 Pressure Gas  
 Max. Basınç : 150 bar  
 Max. load pressure  
 Min. Basınç : 25 bar  
 Min. load pressure  
 Çalışma Sıcaklığı : 0°C ve +80°C  
 Working Temperature  
 Max Çalışma Hızı : 1,8 m / s  
 Max. operating speed



Seri bağlanacak gazlı yaylarda  
**L** ve **Lmin** ölçülerine **+10 mm** eklenecektir .  
 Sipariş için kodlama sonuna **( S )** eklenecektir .  
**YO 11800 - 25 - S**

For the Gas Springs to be connected serial  
**L** and **Lmin** dimensions must be increased **+10 mm**.  
 For the Orders , you must add an **( S )** on the end.  
**YO 6600 - 25 - S**

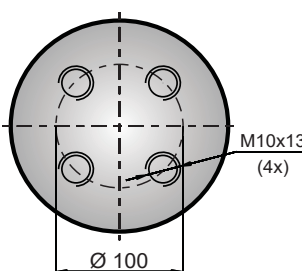
Kod Code	Kurs Stroke	L	Lmin	 daN	 Kg	Alt Görünüm Bottom View
YO 11800-19	19	116	97	6600	~ 9,57	
YO 11800-25	25	128	103		~ 9,96	
YO 11800-32	32	142	110		~ 10,41	
YO 11800-38	38	154	116		~ 10,81	
YO 11800-50	50	178	128		~ 11,59	
YO 11800-63	63	204	141		~ 11,88	
YO 11800-75	75	228	153		~ 12,21	
YO 11800-80	80	238	158		~ 12,43	
YO 11800-100	100	278	178		~ 13,51	
YO 11800-125	125	328	203		~ 15,14	

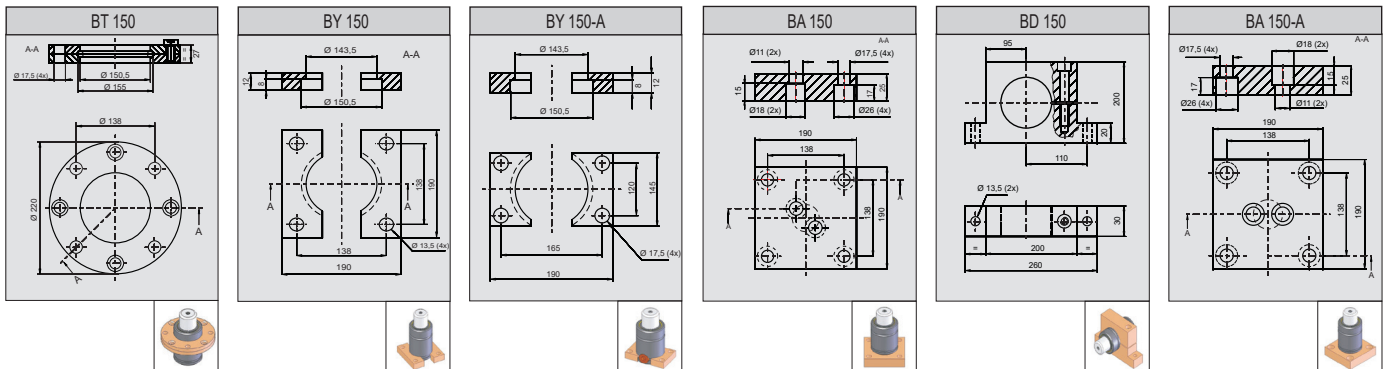

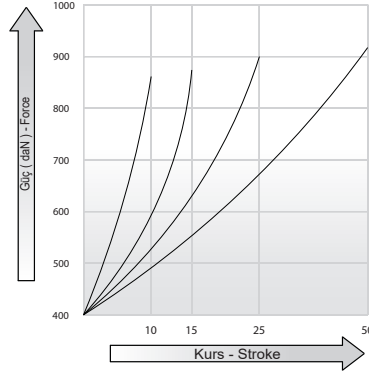
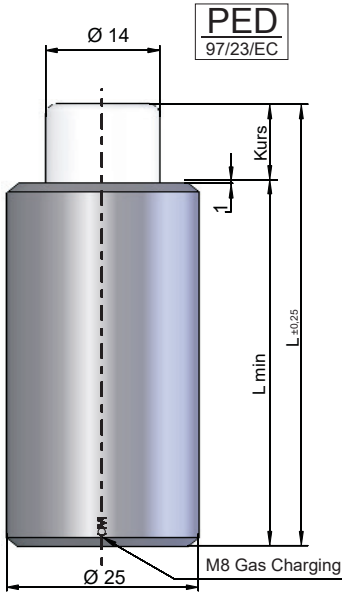

Basınç Gazı : Nitrogen N2  
 Pressure Gas  
 Max. Basınç : 150 bar  
 Max. load pressure  
 Min. Basınç : 25 bar  
 Min. load pressure  
 Çalışma Sıcaklığı : 0°C ve +80°C  
 Working Temperature  
 Max Çalışma Hızı : 1,8 m / s  
 Max. operating speed

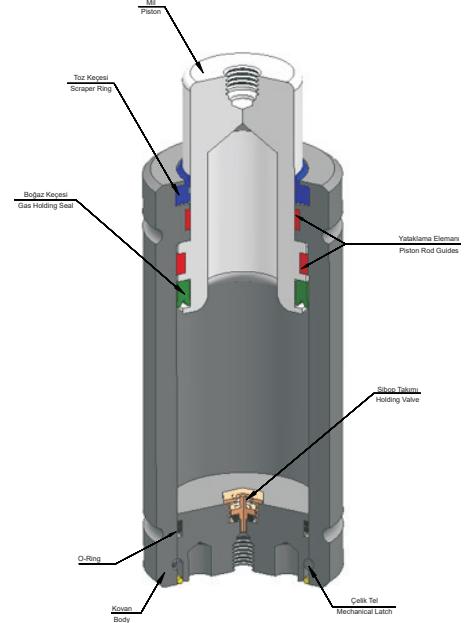

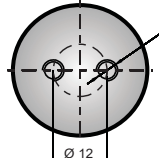
Kod Code	Kurs Stroke	L	Lmin	daN	Kg	Alt Görünüm Bottom View
G 40-10	10	75	65	400	~ 0,18	
G 40-15	15	90	75		~ 0,20	
G 40-25	25	120	95		~ 0,24	
G 40-50	50	195	145		~ 0,35	

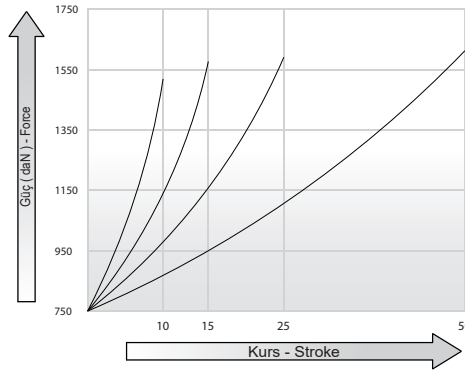
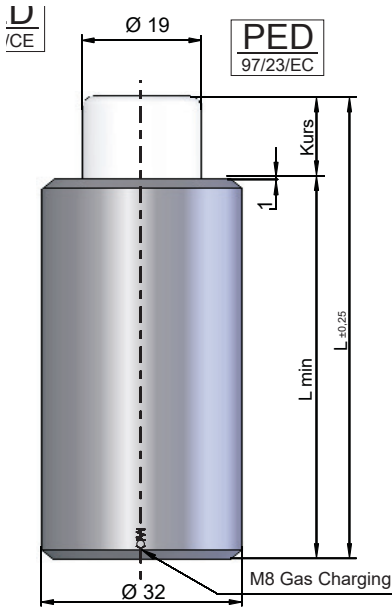

Basınç Gazı : Nitrogen N2  
 Pressure Gas  
 Max. Basınç : 150 bar  
 Max. load pressure  
 Min. Basınç : 25 bar  
 Min. load pressure  
 Çalışma Sıcaklığı : 0°C ve +80°C  
 Working Temperature  
 Max Çalışma Hızı : 1,8 m / s  
 Max. operating speed

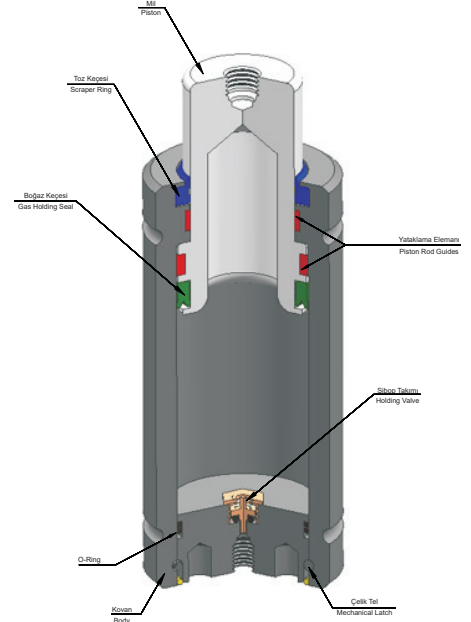

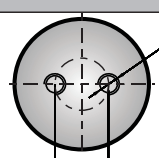

Kod Code	Kurs Stroke	L	Lmin	daN	Kg	Alt Görünüm Bottom View
G 75-10	10	75	65	400	~ 0,18	
G 75-15	15	90	75		~ 0,20	
G 75-25	25	120	95		~ 0,24	
G 75-50	50	195	145		~ 0,35	

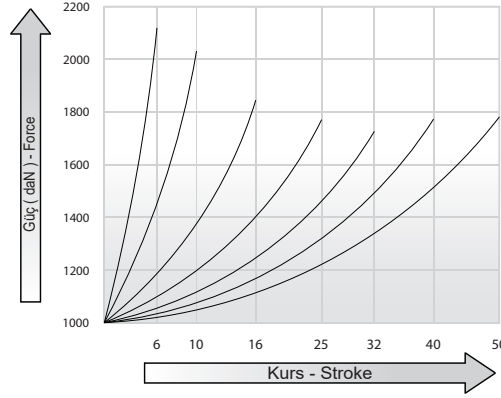
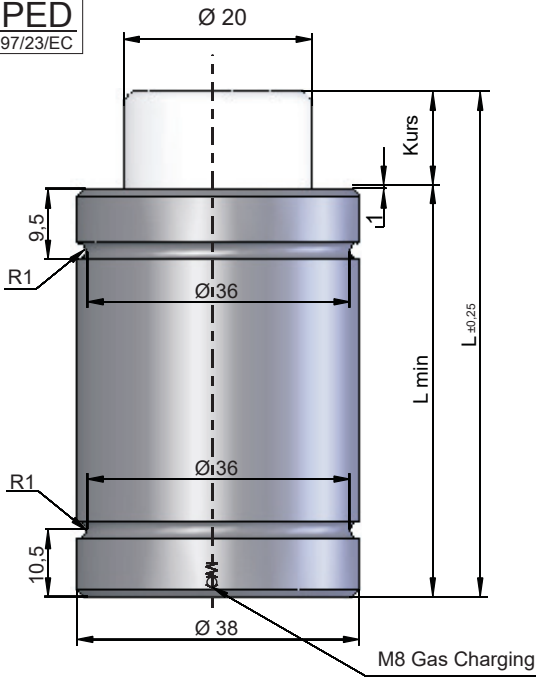

PED  
 97/23/EC

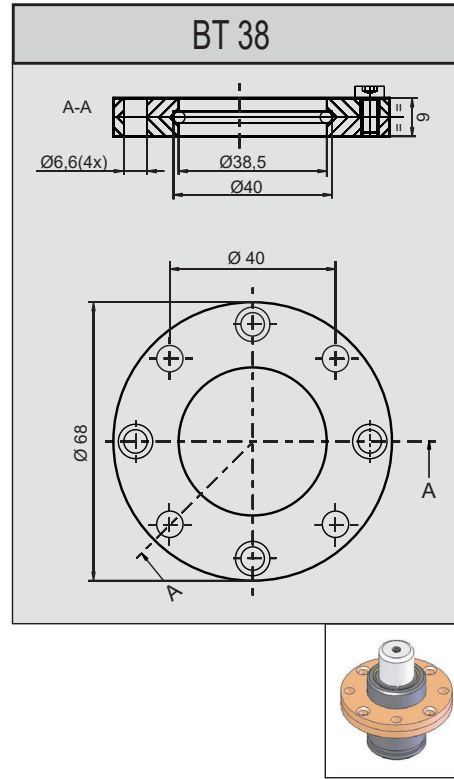
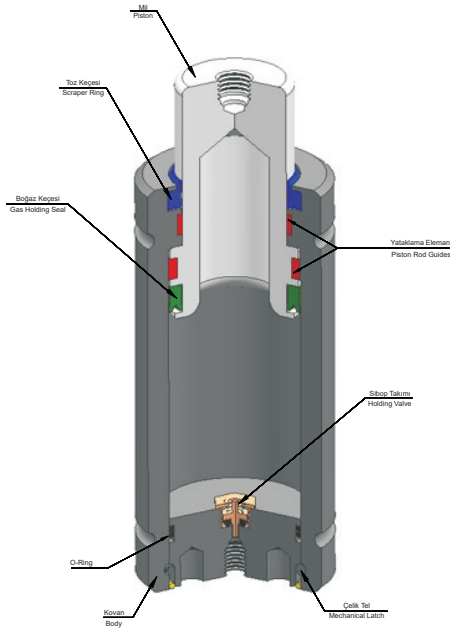
Basınç Gazı : Nitrogen N2  
 Pressure Gas  
 Max. Basınç : 150 bar  
 Max. load pressure  
 Min. Basınç : 25 bar  
 Min. load pressure  
 Çalışma Sıcaklığı : 0°C ve +80°C  
 Working Temperature  
 Max Çalışma Hızı : 1,8 m / s  
 Max. operating speed

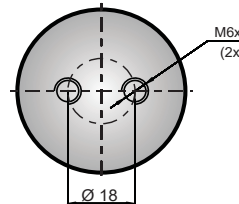

Kod Code	Kurs Stroke	L	Lmin	 daN	 Kg	Alt Görünüm Bottom View
G 100-6	6	61	55	1000	~ 0,36	
G 100-10	10	75	65		~ 0,41	
G 100-16	16	100	84		~ 0,48	
G 100-25	25	135	110		~ 0,58	
G 100-32	32	167	135		~ 0,62	
G 100-40	40	195	155		~ 0,68	
G 100-50	50	230	180		~ 0,74	

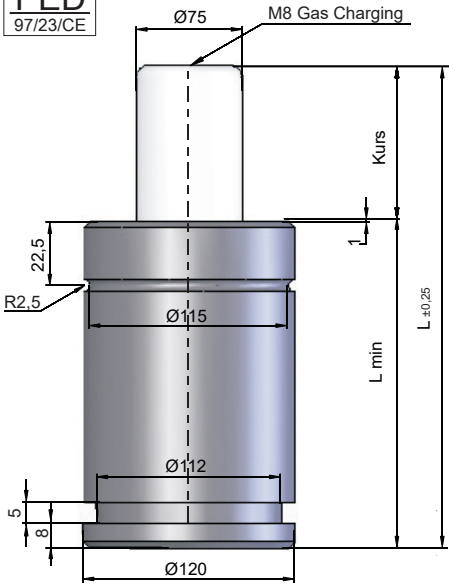
**PED**  
 97/23/CE

Seri Bağlantı Adaptörü

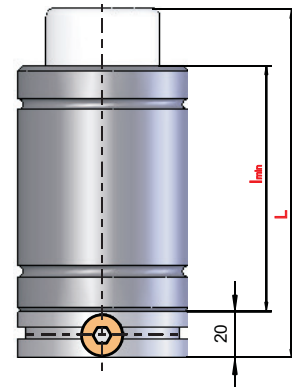
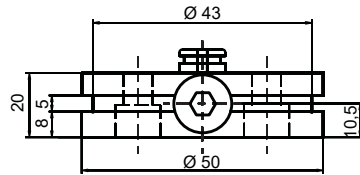
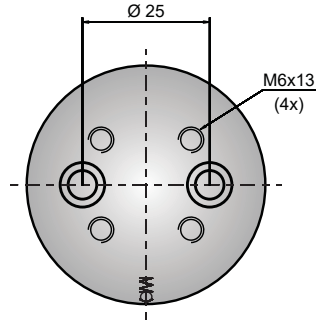
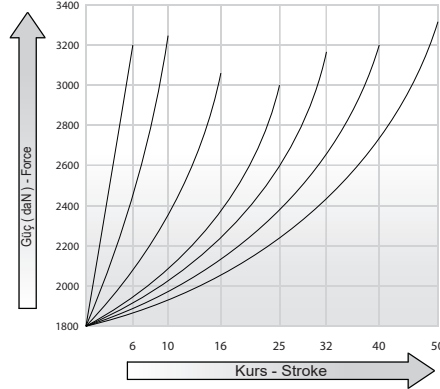
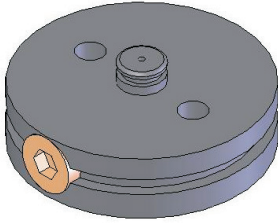

Seri bağlanacak gazlı yaylarda

**L** ve **Lmin** ölçülerine **+20 mm** eklenecektir .  
 Sipariş için kodlama sonuna **(S)** eklenecektir .  
**G 180 - 25 - S**

 For the Gas Springs to be connected serial  
**L** and **Lmin** dimensions must be increased **+20 mm**.  
 For the Orders , you must add an **(S)** on the end.  
**G 180 - 25 - S**

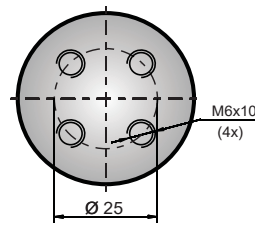
Kod Code	Kurs Stroke	L	Lmin	daN	Kg	Alt Görünüm Bottom View
<b>G 180-6</b>	6	66	60	<b>1800</b>	~ 0,71	
<b>G 180-10</b>	10	80	70		~ 0,78	
<b>G 180-16</b>	16	106	90		~ 0,91	
<b>G 180-25</b>	25	135	110		~ 1,04	
<b>G 180-32</b>	32	162	130		~ 1,12	
<b>G 180-40</b>	40	190	150		~ 1,21	
<b>G 180-50</b>	50	220	170		~ 1,33	

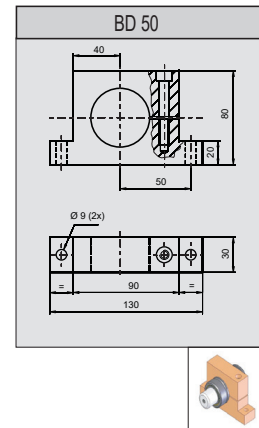
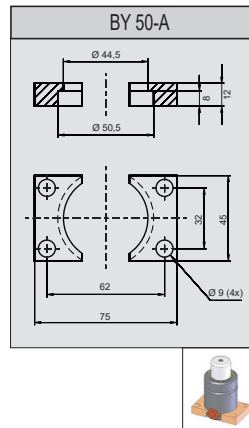
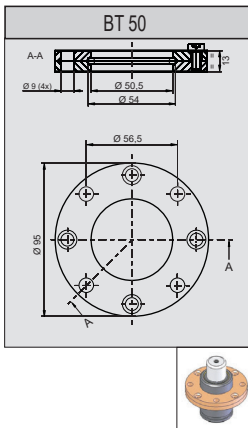

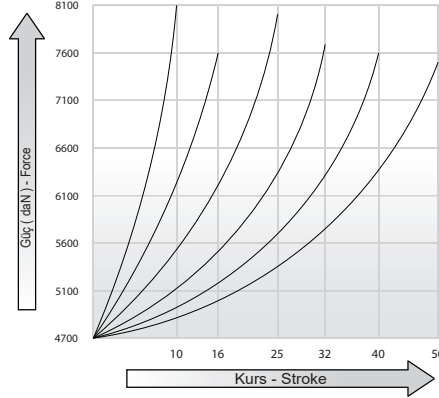
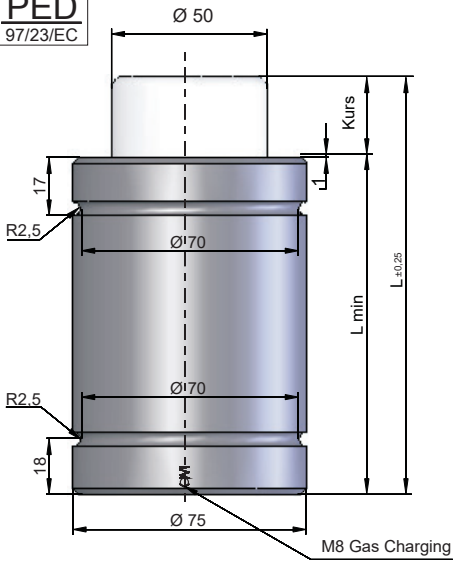
**PED**  
 97/23/EC

Basınç Gazı : Nitrogen N2  
 Pressure Gas  
 Max. Basınç : 150 bar  
 Max. load pressure  
 Min. Basınç : 25 bar  
 Min. load pressure  
 Çalışma Sıcaklığı : 0°C ve +80°C  
 Working Temperature  
 Max Çalışma Hızı : 1,8 m / s  
 Max. operating speed

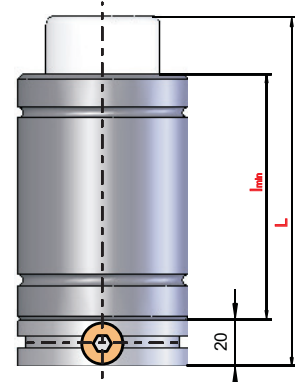

Seri Bağlantı Adaptörü

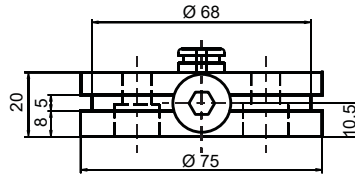
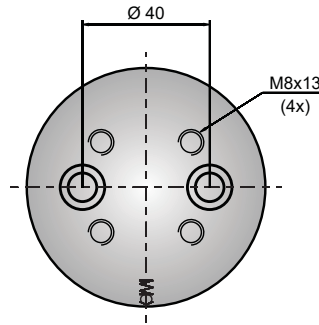
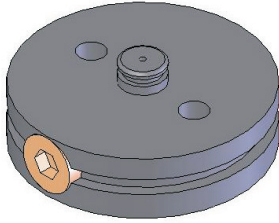

Seri bağlanacak gazlı yaylarda **L** ve **Lmin** ölçülerine **+20 mm** eklenecektir .  
 Sipariş için kodlama sonuna **(S)** eklenecektir .  
**G 470 - 25 - S**

For the Gas Springs to be connected serial **L** and **Lmin** dimensions must be increased **+20 mm**.  
 For the Orders , you must add an **(S)** on the end.  
**G 470 - 25 - S**

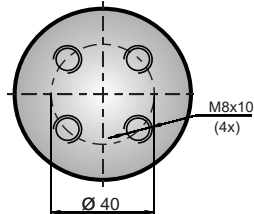
Kod Code	Kurs Stroke	L	Lmin	daN	Kg	Alt Görünüm Bottom View
<b>G 470-10</b>	10	80	70	<b>4700</b>	~ 1,85	
<b>G 470-16</b>	16	106	90		~ 2,11	
<b>G 470-25</b>	25	135	110		~ 2,34	
<b>G 470-32</b>	32	167	135		~ 2,54	
<b>G 470-40</b>	40	200	160		~ 2,77	
<b>G 470-50</b>	50	240	190		~ 3,06	

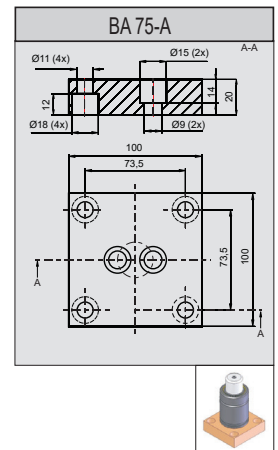
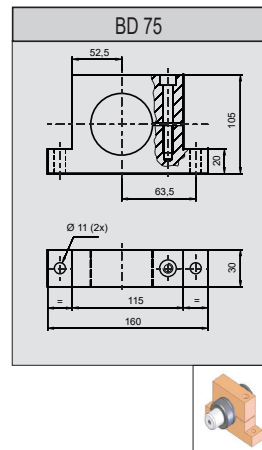
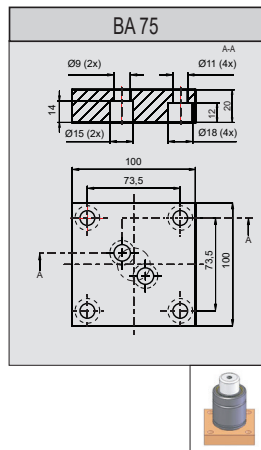
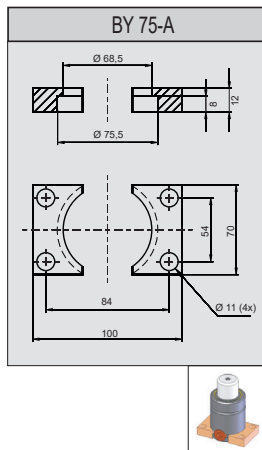
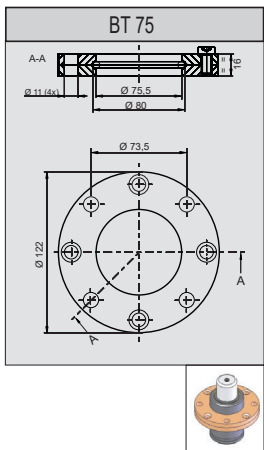

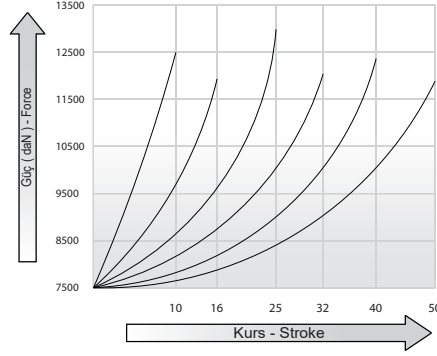
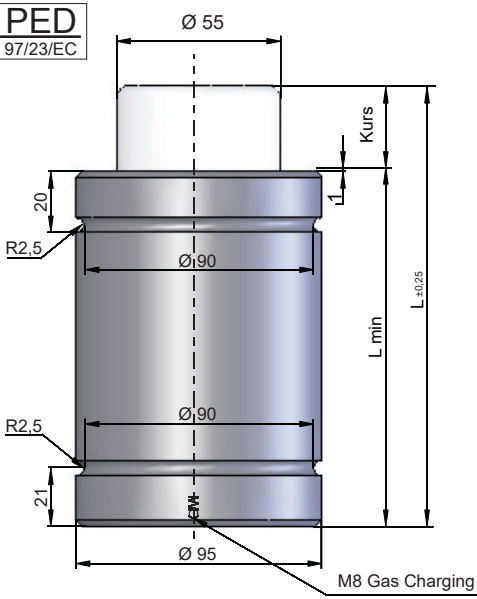

PED  
 97/23/EC

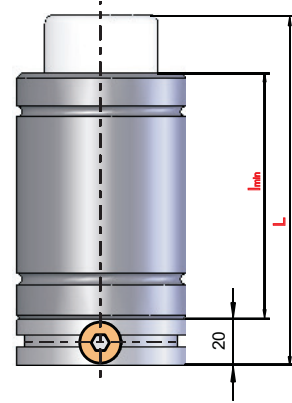
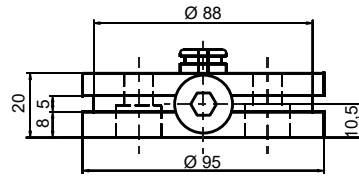
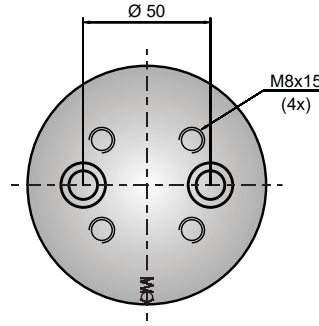
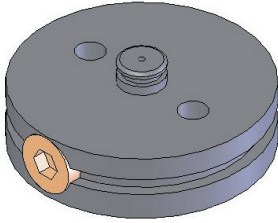
 Basınç Gazı : Nitrogen N2  
 Pressure Gas  
 Max. Basınç : 150 bar  
 Max. load pressure  
 Min. Basınç : 25 bar  
 Min. load pressure  
 Çalışma Sıcaklığı : 0°C ve +80°C  
 Working Temperature  
 Max Çalışma Hızı : 1,8 m / s  
 Max. operating speed

Seri Bağlantı Adaptörü

 Seri bağlanacak gazlı yaylarda **L** ve **Lmin** ölçülerine **+20 mm** eklenecektir .  
 Sipariş için kodlama sonuna **(S)** eklenecektir .  
**G 750 - 25 - S**

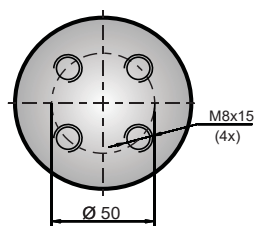
 For the Gas Springs to be connected serial **L** and **Lmin** dimensions must be increased **+20 mm**.  
 For the Orders , you must add an **(S)** on the end.  
**G 750 - 25 - S**

Kod Code	Kurs Stroke	L	Lmin	 daN	 Kg	Alt Görünüm Bottom View
<b>G 750-10</b>	10	90	80	<b>7500</b>	~ 2,94	
<b>G 750-16</b>	16	116	100		~ 3,32	
<b>G 750-25</b>	25	145	120		~ 3,73	
<b>G 750-32</b>	32	182	150		~ 4,32	
<b>G 750-40</b>	40	210	170		~ 4,72	
<b>G 750-50</b>	50	255	205		~ 5,38	

